



VILLAGE OF MOUNT HOREB

E. Main Street

Mount Horeb, WI 53572

Phone: (608) 437-6884 Fax: (608) 437-3190

Email: mhinfo@mounthorebwi.info Web: mounthorebwi.info

PARKS, RECREATION, AND FORESTRY COMMISSION AGENDA

Tuesday, April 22, 2025 at 5:00 PM

Grandma Fosters Park & Grundahl Park

225 W. Main St. & 401 Blue Mounds St.

Mount Horeb, WI

- 1) Call to order
- 2) Roll call
- 3) Consent agenda
 - a. Consideration of March 25, 2025 Meeting Minutes
- 4) Agenda items
 - a. Discussion on Grandma Foster Park planning/improvements
 - b. Discuss Grundahl Park storage needs and future scorekeeper's building with Summer Frolic Committee
 - c. Discuss Grundahl Park scorekeeper's building electrical concerns
 - d. Discussion on Grundahl Park planning/improvements
 - e. Update on kick-off meeting with JSD Professional Services
 - f. Consider the installation of a little free library by the Community Garden Group at Himsel Park
- 5) Department reports
 - a. Recreation Director's Report
 - b. Public Services Director's Report
- 6) Future agenda items
- 7) Set next meeting date and time
- 8) Meeting adjournment

UPON REASONABLE NOTICE, EFFORTS WILL BE MADE TO ACCOMMODATE THE NEEDS OF DISABLED INDIVIDUALS THROUGH APPROPRIATE AIDS AND SERVICES. FOR INFORMATION OR TO REQUEST THIS SERVICE, CONTACT ALYSSA GAFFNEY, CLERK, AT 138 E MAIN STREET, MOUNT HOREB, WI (608) 437-9404.

MINUTES

PARKS, RECREATION AND FORESTRY COMMISSION

March 25, 2025, 5:30 PM, Municipal Building Board Room

PRESENT: Halverson, Adler, White, Mertz.

ABSENT: Honore, Hogseth, Webber

OTHERS PRESENT: Owen, Gorman – Village of Mount Horeb

Consider minutes of the February 25, 2025 meeting.

White moved; Mertz seconded to approve the minutes of the February 25, 2025 meeting. Motion carried.

Consider playground options for Grundahl Park

Kyla Reamon from Gerber Leisure products was present to review the playground proposal and answer any questions. Some changes were highlighted based on feedback from the last meeting. Kyla also reviewed some of the possible color pallets. The Commission agreed to use the color combinations that were included in the proposal. White moved, Mertz seconded to approve the playground as presented. Motion carried.

Consider recommendation of JSD for park master planning at former Lukken property

Owen said a subcommittee interviewed consultants for the master planning process and decided on JSD Professional Services due to their comprehensive proposal and cost. Adler moved, White seconded to approve the proposal from JSD. Motion carried.

Discuss Grundahl Park storage needs with the Summer Frolic Committee

Halverson tabled the discussion until next month.

Discuss electrical issues at the Grundahl ball diamond facility

Gorman will discuss the issues with E&S Electric when they are on site working on the ball diamond lights and discuss further next month.

Consider replacing basketball goals at Ibinger Ridge Park and Valley View Park

Gorman would like to replace two basketball goals at Valley View Park and one goal at Ibinger Ridge Park since the height adjustment mechanisms are broke and the goals do not move. The current goals were installed in 2008. Gorman stated the cost for all three goals with freight and installation is approximately \$9,000 and they would be funded with the Park Development Fund. Adler moved, Mertz seconded to approve the purchase of the three goals with the Park Development Fund. Motion carried.

Mount Horeb Area Community Garden annual report presentation

Lynn Messinger reviewed the Community Garden annual report. This was the seventh year that the garden has been in existence. Messinger also stated that the group would like permission to install a little free library at the garden. Owen said that should be an agenda item at the next meeting.

Recreation Director's Report

Dudley was not present but submitted a report. The Commission reviewed her written report.

Public Services Director's Report

Gorman reviewed his written report.

Future agenda items

- Foster Park review and planning
- Grundahl Park storage with Summer Frolic
- Grundahl Park electrical issues at ball diamond shelter
- Consider little free library at community garden

Set next meeting date and time

April 22, 2025 at 5:00 pm starting at Grandma Foster Park, then proceeding to Grundahl Park

Adjourn

White moved, Adler seconded to adjourn at 6:12 pm. Motion carried.

Minutes prepared by Jeff Gorman, Public Services Director

DRAFT



AGENDA ITEM REPORT

MEETING DATE

April 22, 2025

PREPARED BY

AGENDA ITEM # 4.a

Discussion on Grandma Foster Park planning/improvements

BACKGROUND

RECOMMENDATION

ATTACHMENTS

1. Grandma Foster master



VILLAGE BOARD MEETING

GRANDMA FOSTER + GRUNDAHL PARK

October 4th, 2023



Grandma Foster Park

CHARACTER IMAGERY

Village of Mount Horeb, Wisconsin
March 27th, 2023



AMENITIES

Open-Air Shelter



Wayfinding Sign



Grand Entrance Stairs



ACTIVITIES

Troll Play Feature (Earthscape)



Sensory Play



Wayfinding - Troll Footprints



Traditional Play



Plaza - Pavement Pattern



Plantings



EXPERIENCE

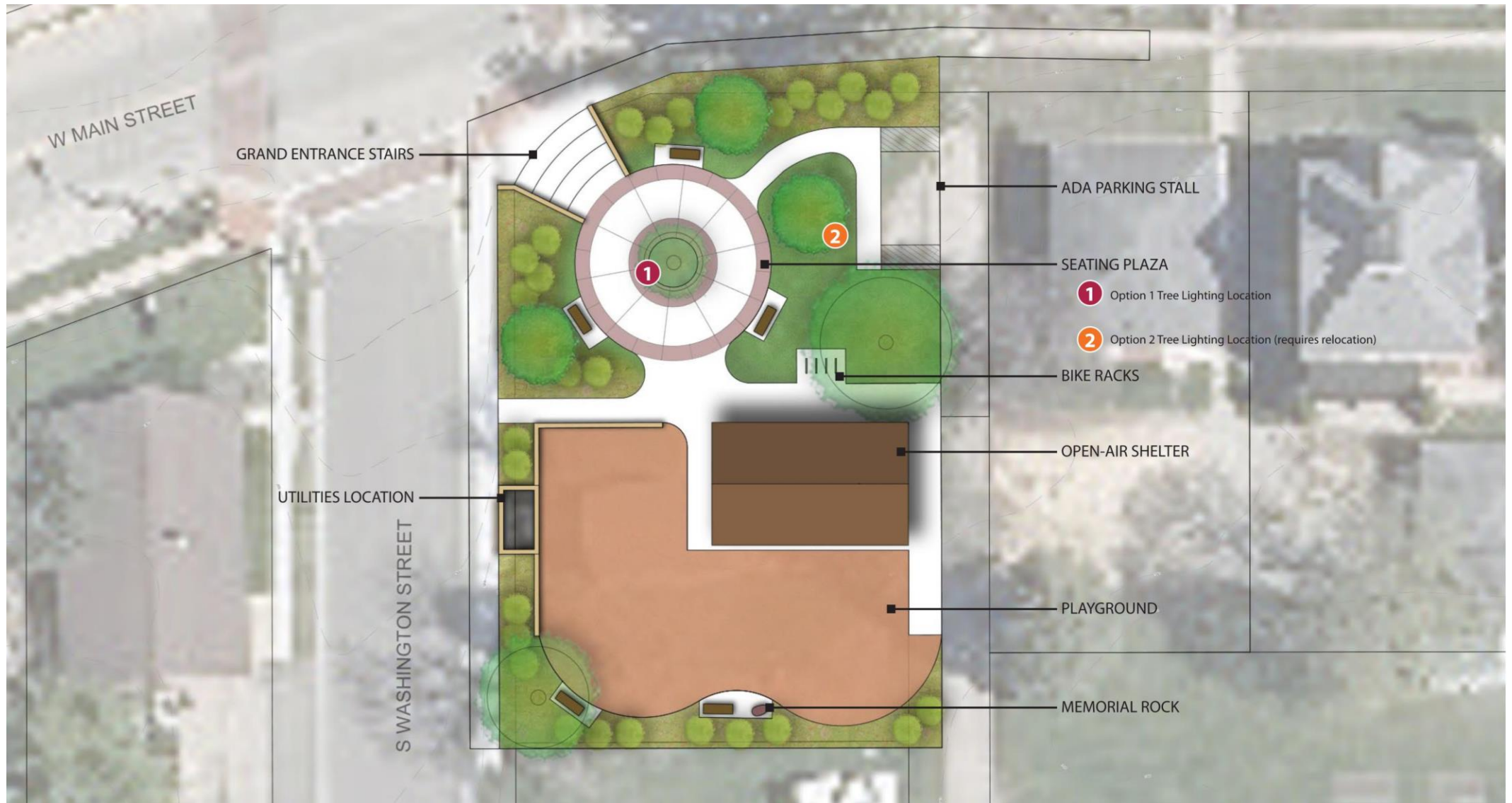

Master Plan

LEGEND

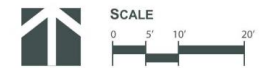

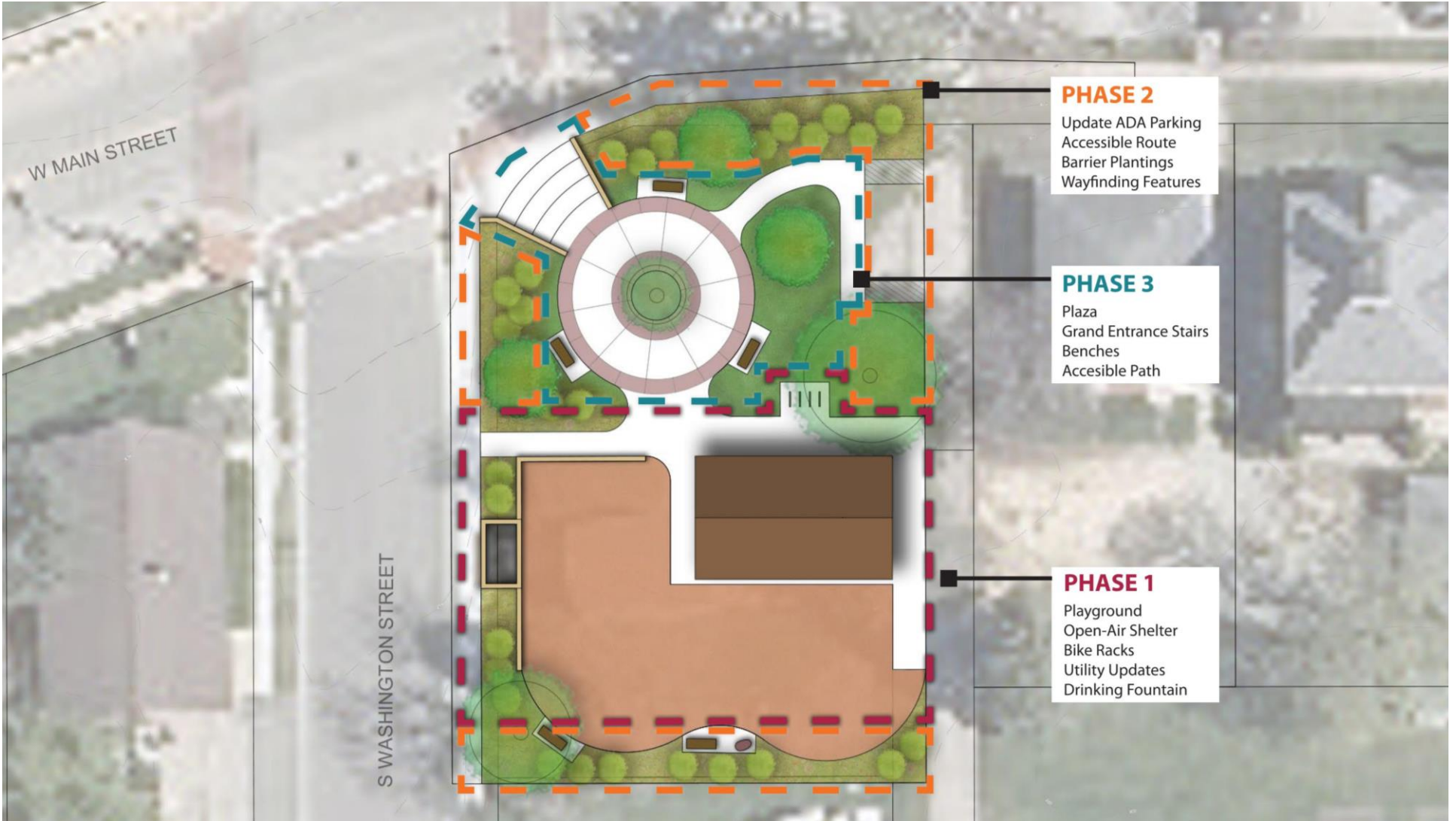

Phase 1: \$360,000

Phase 2: \$37,000

Phase 3: \$119,000

Phasing Plan

TO FRONT STREET
↓

STRUCTURES + SPACE

Multi-Use Event and Programming Space



Wednesday Night Live Concert Series



ACTIVITIES

Pickleball Courts



Basketball Courts



3-Season Park Shelter



Native Plantings



Playground



Octagonal Shelter (Existing)



Sledding Hill



Batting Cages



PLACES

Master Plan

LEGEND



Proposed Tree



Existing Tree

- 1** Maintain Ex. Parking, New Sidewalk (25 stalls)
 - 2** Announcer Booth Addition
 - 3** Dugout Improvements
 - 4** Field Improvements
 - 5** Batting Cages (2)
 - 6** Pickleball Courts (2)
 - 7** Stormwater Area
 - 8** Basketball Court (1)
 - 9** Playground (5,800 SF)
 - 10** Maintain Existing Shelter
 - 11** Maintain Ex. Parking (56 stalls - 2 ADA)
 - 12** Expand Parking (19 stalls - 1 ADA)
 - 13** Multi-Use Event Building
 - 14** New Shelter, Restrooms and Kitchen
 - 15** Native Plantings
 - 16** Regrade for Open Field Space
 - 17** Maintain Community Stage
 - 18** Angled Parking (11 stalls - 1 ADA)
- Total Cost:** \$8,993,000
- Inflation Total:** \$11,906,725
- Items >\$250,000
- Multi-Use Event Building \$450,000
 - New Restroom/Kitchen/Shelter Facility \$650,000
 - Accessible Pathways - \$355,000



PHASE 1

LEGEND



Proposed Tree



Existing Tree

PHASE 1

- Playground 1
- Basketball Court 2
- Existing Shelter Structural Analysis (Octagonal) 3
- Baseball Improvements Phase #1 4

PHASE 2

- Batting Cages
- Baseball Improvements Phase #2
- Accessible Routes and Parking

PHASE 3

- Community Stage Updates
- Existing Shelter Updates (Octagonal)
- Pickleball Courts
- Restroom/Kitchen/Shelter Facility

PHASE 4

- Multi-Purpose Building
- Field Space Renovation



Phase 1: \$975,450 (2025)

Total: \$11,906,725

PHASE 2

LEGEND



Proposed Tree

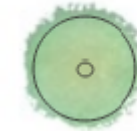

Existing Tree

PHASE 1

- Playground
- Basketball Court
- Existing Shelter Structural Analysis (Octagonal)
- Baseball Improvements Phase #1

PHASE 2

- Batting Cages **1**
- Baseball Improvements Phase #2 **2**
- Accessible Routes **3**
- Parking Additions **4**

PHASE 3

- Community Stage Updates
- Existing Shelter Updates (Octagonal)
- Pickleball Courts
- Restroom/Kitchen/Shelter Facility

PHASE 4

- Multi-Purpose Building
- Field Space Renovation

Phase 2: \$1,460,800
(2027)

Total: \$11,906,725



Phase 3

LEGEND



Proposed Tree

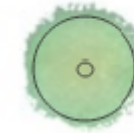

Existing Tree

PHASE 1

- Playground
- Basketball Court
- Existing Shelter Structural Analysis (Octagonal)
- Baseball Improvements Phase #1

PHASE 2

- Batting Cages
- Baseball Improvements Phase #2
- Accessible Routes and Parking

PHASE 3

- Community Stage Updates ①
- Existing Shelter Updates (Octagonal) ②
- Pickleball Courts ③
- Restroom/Kitchen/Shelter Facility ④

PHASE 4

- Multi-Purpose Building
- Field Space Renovation



Phase 3: \$1,552,175
(2030)

Total: \$11,906,725

Phase 4

LEGEND



Proposed Tree

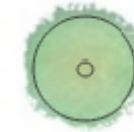

Existing Tree

PHASE 1

- Playground
- Basketball Court
- Existing Shelter Structural Analysis (Octagonal)
- Baseball Improvements Phase #1

PHASE 2

- Batting Cages
- Baseball Improvements Phase #2
- Accessible Routes and Parking

PHASE 3

- Community Stage Updates
- Existing Shelter Updates (Octagonal)
- Pickleball Courts
- Restroom/Kitchen/Shelter Facility

PHASE 4

- Multi-Purpose Building ①
- Field Space Renovation ②
- Native Plantings ③



Phase 4: \$7,918,300
(2035)

Total: \$11,906,725



Discussion - Questions – Comments

GRANDMA FOSTER + GRUNDAHL PARK

October 4th, 2023



ESTIMATE YEAR:					2023
ITEM NO.	DESCRIPTION	QTY.	UNIT	UNIT PRICE	TOTAL PRICE
PHASE 1					
1	Open Prefabricated Park Shelter (25x40)	1	LS	\$65,000	\$65,000
2	6' Benches	2	EA	\$2,000	\$4,000
3	Bike Racks	4	EA	\$700	\$2,800
4	Trash Cans	2	EA	\$1,500	\$3,000
5	Drinking Fountain	1	EA	\$9,000	\$9,000
6	6' Picnic Tables	3	EA	\$2,500	\$7,500
7	Concrete Park Path - 5' + Pads (est.)	1,200	SF	\$10	\$12,000
8	Playground Area (3,200 SF)	1	LS	\$150,000	\$150,000
9	Earthwork (est.)	1	LS	\$4,000	\$4,000
10	Site Restoration - Lawn (est.)	100	SY	\$4	\$400
11	Landscaping (est.)	1,000	SF	\$8	\$8,000
12	Shelter Electrical Service (est.)	1	LS	\$5,000	\$5,000
13	Water Service (est.)	1	LS	\$3,000	\$3,000
14	Stormwater (est.)	1	LS	\$5,000	\$5,000
15	Erosion Control	1	LS	\$2,500	\$2,500
16	General Conditions/Mobilization (8%)	1	LS	\$12,000	\$12,000
PHASE 1 CONSTRUCTION SUBTOTAL					\$294,000
Contingency 10%					\$30,000
Design Engineering & Bidding 6%					\$18,000
Construction Administration 6%					\$18,000
PHASE 1 TOTAL					\$360,000

GRANDMA FOSTER PARK COSTS

PHASE 2					
5	Earthwork (est.)	1	LS	\$3,000	\$3,000
6	Site Restoration - Lawn (est.)	60	SY	\$4	\$240
7	Landscaping (est.)	1,000	SF	\$8	\$8,000
8	Trees	3	EA	\$500	\$1,500
9	Park Sign	1	LS	\$5,000	\$5,000
10	Stormwater (est.)	1	LS	\$2,000	\$2,000
11	Erosion Control	1	LS	\$2,000	\$2,000
12	General Conditions/Mobilization (8%)	1	LS	\$8,000	\$8,000
PHASE 2 CONSTRUCTION SUBTOTAL					\$30,000
Contingency 10%					\$3,000
Design Engineering & Bidding 6%					\$2,000
Construction Administration 6%					\$2,000
PHASE 2 TOTAL					\$37,000
PHASE 3					
1	6' Benches	3	EA	\$2,000	\$6,000
2	Concrete Park Path - 5' + Pads (est.)	1,800	SF	\$10	\$18,000
3	ADA Parking	1	LS	\$3,500	\$3,500
4	Grand Entrance Stairs	1	LS	\$50,000	\$50,000
5	Earthwork (est.)	1	LS	\$3,000	\$3,000
6	Site Restoration - Lawn (est.)	60	SY	\$4	\$240
7	Landscaping (est.)	70	SF	\$8	\$560
10	Stormwater (est.)	1	LS	\$3,000	\$3,000
11	Erosion Control	1	LS	\$500	\$500
12	General Conditions/Mobilization (8%)	1	LS	\$12,000	\$12,000
PHASE 3 CONSTRUCTION SUBTOTAL					\$97,000
Contingency 10%					\$10,000
Design Engineering & Bidding 6%					\$6,000
Construction Administration 6%					\$6,000
PHASE 3 TOTAL					\$119,000
PROJECT TOTAL COST:					\$516,000

ESTIMATE YEAR:					2023
ITEM NO.	DESCRIPTION	QTY.	UNIT	UNIT PRICE	TOTAL PRICE
1	Improve/Addition to Existing Concessions	1	LS	\$150,000	\$150,000
2	6' Benches	5	EA	\$2,000	\$10,000
3	Trash Cans	6	EA	\$1,500	\$9,000
4	Bike Racks	5	EA	\$500	\$2,500
5	Concrete Park Path - 5' + 10' + Pads (est.)	5,000	SF	\$10	\$50,000
6	Asphalt Path - 10'	1,500	SF	\$8	\$12,000
7	Playground Area (5840 SF)	1	LS	\$200,000	\$200,000
8	Basketball Court	1	LS	\$90,000	\$90,000
9	Improve Existing Baseball Field	1	LS	\$90,000	\$90,000
10	Site Lighting (light poles)	3	EA	\$5,000	\$15,000
11	Earthwork (est.)	1	LS	\$20,000	\$20,000
12	Site Restoration - Lawn	1,000	SY	\$3	\$3,000
13	Stormwater Areas	1,500	SF	\$8	\$12,000
14	Upgrade Electrical Service (est.)	1	LS	\$7,000	\$7,000
15	Storm Sewer (est.)	1	LS	\$15,000	\$15,000
16	Erosion Control	1	LS	\$7,000	\$7,000
17	General Conditions/Mobilization (8%)	1	LS	\$56,000	\$56,000
CONSTRUCTION SUBTOTAL					\$749,000
Contingency 10%					\$75,000
Design Engineering & Bidding 6%					\$45,000
Structural Assessment of Existing Shelter LS					\$15,000
Construction Administration 6%					\$45,000
PHASE 1 TOTAL COST:					\$929,000
					2025 \$975,450

ESTIMATE YEAR:					2023
ITEM NO.	DESCRIPTION	QTY.	UNIT	UNIT PRICE	TOTAL PRICE
1	Trash Cans	2	EA	\$1,500	\$3,000
2	Bike Racks	10	EA	\$500	\$5,000
3	Drinking Fountain	1	EA	\$9,000	\$9,000
4	Concrete Park Path - 5' + 10' + Pads (est.)	26,000	SF	\$10	\$260,000
5	Asphalt Path - 10'	9,500	SF	\$8	\$76,000
6	New Asphalt Parking (# stalls)	12,000	SF	\$8	\$96,000
7	Improved Asphalt Parking	27,500	SF	\$8	\$220,000
8	Improve Existing Baseball Field	1	LS	\$60,000	\$60,000
9	Ballfield Lighting (6 poles)	1	LS	\$180,000	\$180,000
10	Site Lighting (light poles)	5	EA	\$5,000	\$25,000
11	Earthwork (est.)	1	LS	\$10,000	\$10,000
12	Landscaping (est.)	50	SF	\$8	\$400
13	Site Restoration - Lawn	800	SY	\$3	\$2,400
14	Stormwater Areas	3,300	SF	\$8	\$26,400
15	Trees	11	EA	\$500	\$5,500
16	Park Sign	1	LS	\$5,000	\$5,000
17	Water Service (est.)	1	LS	\$3,000	\$3,000
18	Storm Sewer (est.)	1	LS	\$15,000	\$15,000
19	Erosion Control	1	LS	\$5,000	\$5,000
20	General Conditions/Mobilization (8%)	1	LS	\$80,000	\$80,000
CONSTRUCTION SUBTOTAL					\$1,087,000
Contingency 10%					\$109,000
Design Engineering & Bidding 6%					\$66,000
Construction Administration 6%					\$66,000
PHASE 2 TOTAL COST:					\$1,328,000
					2027 \$1,460,800

GRUNDAHL PARK COSTS

ESTIMATE YEAR:				2023	
ITEM NO.	DESCRIPTION	QTY.	UNIT	UNIT PRICE	TOTAL PRICE
1	New Restroom/Kitchen/Shelter Facility (4,500 SF)	1	LS	\$650,000	\$650,000
2	Existing Octagonal Shelter Improvements	1	LS	\$100,000	\$100,000
3	6' Benches	5	EA	\$2,000	\$10,000
4	Trash Cans	2	EA	\$1,500	\$3,000
5	Bike Racks	5	EA	\$500	\$2,500
6	6' Picnic Tables	4	EA	\$2,000	\$8,000
7	Drinking Fountain	1	EA	\$9,000	\$9,000
8	Concrete Park Path - 5' + 10' + Pads (est.)	3,500	SF	\$10	\$35,000
9	Pickleball Courts	2	EA	\$60,000	\$120,000
9	Site Lighting (light poles)	2	EA	\$5,000	\$10,000
10	Earthwork (est.)	1	LS	\$10,000	\$10,000
11	Landscaping (est.)	100	SF	\$8	\$800
12	Site Restoration - Lawn	500	SY	\$3	\$1,500
13	Stormwater Areas	500	SF	\$8	\$4,000
14	Trees	9	EA	\$500	\$4,500
15	Upgrade Electrical Service (est.)	1	LS	\$9,000	\$9,000
16	Water Service (est.)	1	LS	\$4,000	\$4,000
17	Sanitary Sewer (est.)	1	LS	\$5,000	\$5,000
18	Storm Sewer (est.)	1	LS	\$10,000	\$10,000
19	Erosion Control	1	LS	\$5,000	\$5,000
20	General Conditions/Mobilization (8%)	1	LS	\$80,000	\$80,000
CONSTRUCTION SUBTOTAL					\$1,082,000
Contingency 10%					\$109,000
Design Engineering & Bidding 6%					\$65,000
Construction Administration 6%					\$65,000
PHASE 3 TOTAL COST:					\$1,321,000
					2030
					\$1,552,175

ESTIMATE YEAR:				2023	
ITEM NO.	DESCRIPTION	QTY.	UNIT	UNIT PRICE	TOTAL PRICE
1	Multi-Use Event Building (20,000 SF)	1	LS	\$4,500,000	\$4,500,000
2	Drinking Fountain	1	EA	\$9,000	\$9,000
3	Concrete Park Path - 5' + 10' + Pads (est.)	1,000	SF	\$10	\$10,000
4	Earthwork (est.)	1	LS	\$40,000	\$40,000
5	Landscaping (est.)	450	SF	\$8	\$3,600
6	Site Restoration - Lawn	2,075	SY	\$3	\$6,225
7	Native Areas - seeding and maintenance (est.)	4,000	SY	\$4	\$16,000
8	Stormwater Areas	500	SF	\$8	\$4,000
9	Site Lighting (light poles)	1	EA	\$5,000	\$5,000
9	Upgrade Electrical Service (est.)	1	LS	\$9,000	\$9,000
10	Water Service (est.)	1	LS	\$3,000	\$3,000
11	Sanitary Sewer (est.)	1	LS	\$10,000	\$10,000
12	Storm Sewer (est.)	1	LS	\$10,000	\$10,000
13	Erosion Control	1	LS	\$8,000	\$8,000
14	General Conditions/Mobilization (8%)	1	LS	\$357,000	\$357,000
CONSTRUCTION SUBTOTAL					\$4,991,000
Contingency 10%					\$500,000
Design Engineering & Bidding 6%					\$300,000
Construction Administration 6%					\$300,000
PHASE 4 TOTAL COST:					\$6,091,000
					2035
					\$7,918,300

Phased Costs with Inflation (2.5% per year)			
Phase 1	2025	\$	975,450
Phase 2	2027	\$	1,460,800
Phase 3	2030	\$	1,552,175
Phase 4	2035	\$	7,918,300
TOTAL COST OF ALL PHASES WITH INFLATION			\$ 11,906,725

GRUNDAHL PARK COSTS



AGENDA ITEM REPORT

MEETING DATE

April 22, 2025

PREPARED BY

AGENDA ITEM # 4.b

Discuss Grundahl Park storage needs and future scorekeeper's building with Summer Frolic Committee

BACKGROUND

RECOMMENDATION

ATTACHMENTS

1. Grundahl scorekeepers building concept plan

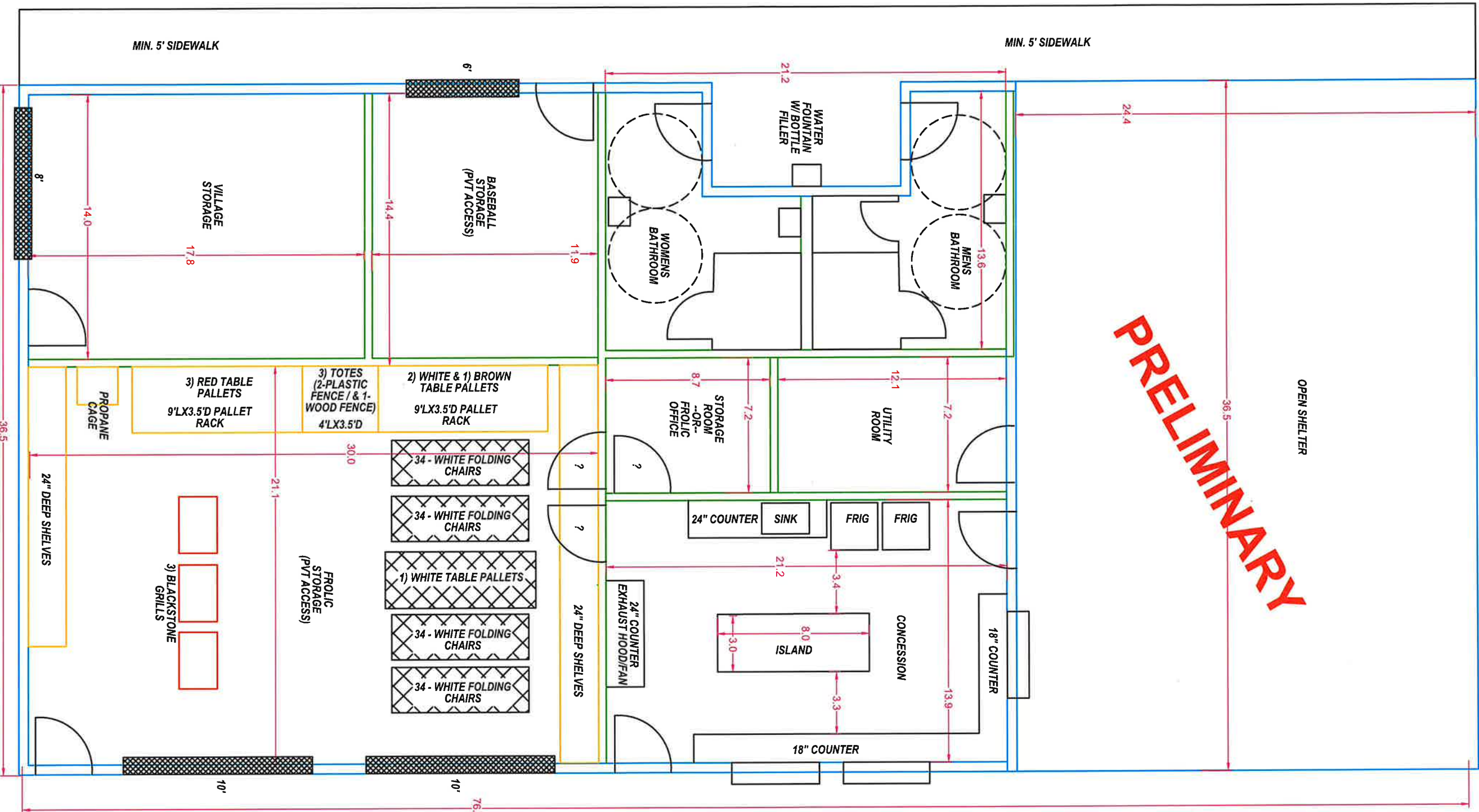

PRELIMINARY



INTERIOR PROGRAMMING:

- FINAL DIMENSIONS WILL BE ADJUSTED TO STANDARD LENGTHS/WIDTHS.
- PLACE BATHROOMS ON WEST SIDE OF BLDG TO CREATE MORE PRIVACY FOR THOSE ENTERING & TO HAVE VISIBILITY FROM STREET & PUBLIC SAFETY BLDG TO REDUCE CHANCES OF VANDALISM.
- CONCESSION COULD HAVE A FOB & BE RENTED IF THERE IS A DESIRE IN THE FUTURE. CONCESSION COULD HAVE EXHAUST HOOD SIMILAR TO LOWER GRUNDAHL SHELTER TO ALLOW GRILLING INSIDE FOR FROLIC.
- OPEN SHELTER AREA LOCATED ON NORTH END OF THE STRUCTURE NEAR OPEN GRASS AREA. THIS WILL HELP KEEP KIDS AWAY FROM PARKING LOT
- OVERHEAD DOORS FOR FROLIC ON EAST SIDE SO CAN MOVE SKIDS ON PAVEMENT AREA.
- OVERHEAD DOOR FOR VILLAGE ON SOUTH SO CAN ACCESS ON PAVEMENT
- BASEBALL STORAGE DOOR ON WEST - MINIMAL VEHICULAR TRAFFIC SO NO PAVEMENT SHOULD BE NEEDED.
- 2X6 EXTERIOR CONSTRUCTION
- 2X4 INTERIOR CONSTRUCTION

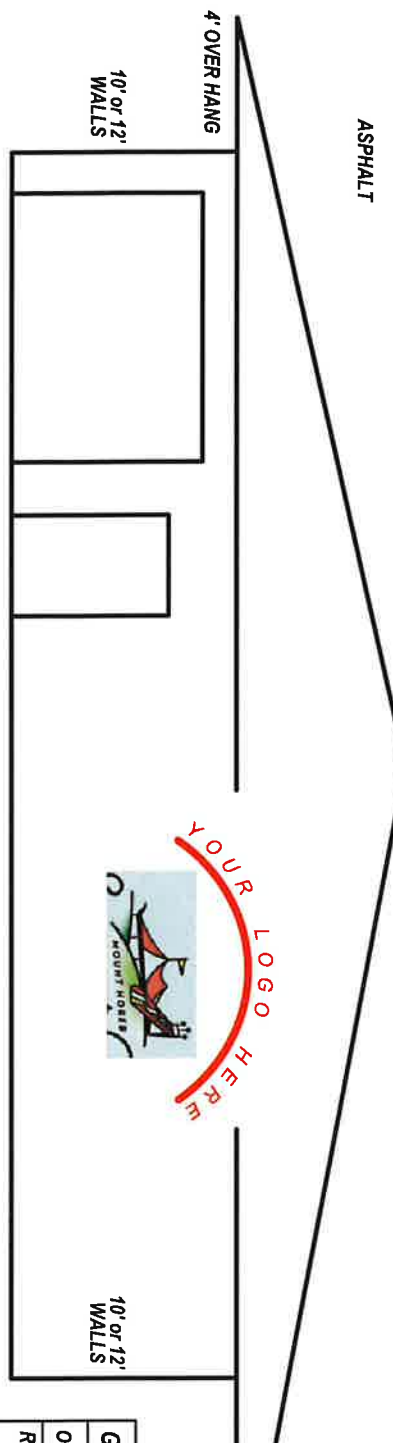

GRUNDAHL BASEBALL CONCESSION STAND
 ~2750 SQFT
 ORIGINAL DRAWING: 3/10/2025
 REVISION DATES: 3/16/25, 4/10/25



- EXTERIOR PROGRAMMING:**
- ELECTRICAL PADMOUNT TRANSFORMER TO BE MOVED CLOSER TO RISER POLE ALONG BLUE MOUNDS STREET
 - TELEPHONE CABLE TO BE RELOCATED. WILL NEED TO MAKE ACCOMMODATIONS FOR MHTC WIRELESS EQUIPMENT.
 - ADD DRINKING AND WATER BOTTLE FILLER AND ELIMINATE CURRENT WATER FOUNTAIN? THIS ALLOW TO "SLIDE" THE NEW BUILDING SOUTH OF THE CURRENT LOCATION.
 - SWALE TO BE INSTALLED ON WEST SIDE OF BUILDING FOR DRAINAGE.
 - MOVE BLEACHERS NORTH OF THE SHELTER TO CREATE CLEAR SPACE FOR OVERHEAD DOORS AND VIEW OF FIELD FROM CONCESSION STAND?
 - ENSURE EXISTING WOOD POLE THAT SUPPORTS THE BACKSTOP NETTING IS NOT IN CONFLICT WITH OVERHEAD DOORS AND STORAGE ACCESS.

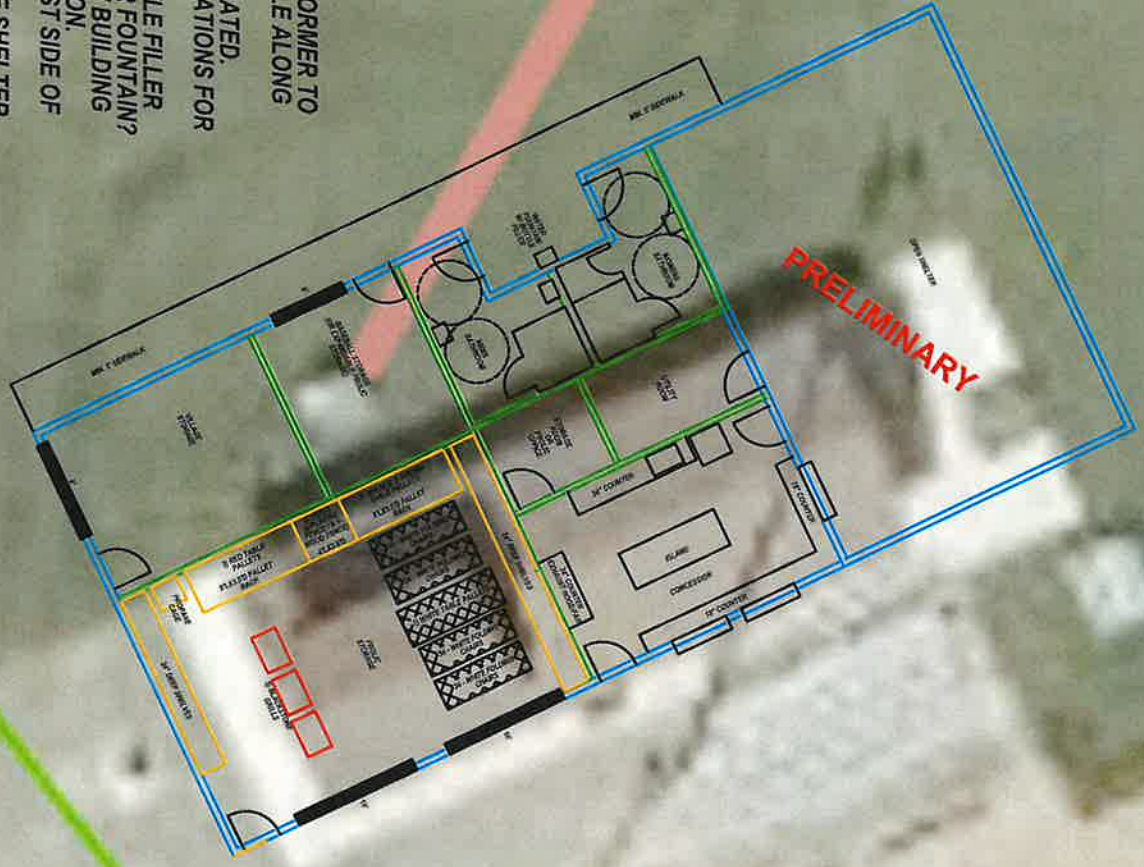

GRUND AHL BASEBALL CONCESSION STAND	
ORIGINAL DRAWING:	3/10/2025
REVISION DATES:	3/6/25 4/10/25
5-A	KA



AGENDA ITEM REPORT

MEETING DATE

April 22, 2025

PREPARED BY

AGENDA ITEM # 4.c

Discuss Grundahl Park scorekeeper's building electrical concerns

BACKGROUND

RECOMMENDATION

ATTACHMENTS

None



AGENDA ITEM REPORT

MEETING DATE

April 22, 2025

PREPARED BY**AGENDA ITEM # 4.d**

Discussion on Grundahl Park planning/improvements

BACKGROUND**RECOMMENDATION****ATTACHMENTS**

None



AGENDA ITEM REPORT

MEETING DATE

April 22, 2025

PREPARED BY

AGENDA ITEM # 4.e

Update on kick-off meeting with JSD Professional Services

BACKGROUND

RECOMMENDATION

ATTACHMENTS

None



AGENDA ITEM REPORT

MEETING DATE

April 22, 2025

PREPARED BY

AGENDA ITEM # 4.f

Consider the installation of a little free library by the Community Garden Group at Himsel Park

BACKGROUND

RECOMMENDATION

ATTACHMENTS

None



Village of Mount Horeb Recreation Department

105 North Grove Street
Mount Horeb, WI 53572

Phone (608) 437-3400 | Email: jill.dudley@mounthorebwi.info

PARKS, RECREATION, AND FORESTRY COMMISSION

April 22, 2025

Recreation Director's Report

1. April Program Numbers:

<u>Program Name</u>	<u>2025 Participants</u>	<u>2024 Participant Numbers</u>
Martial Arts Session #5	6	12
Babysitting Class	10	16
Toddler Folk Art	8	9
YEL! Track & Field	18	16
Toddler Yoga Session #5	4	N/A (new spring program)
Fun with Volleyball	48	60
YEL! Robotics	5	9
After School Art Class	10	21
Taekwondo	10 (one session)	20 (two sessions)
Grow A Flower Garden	2	N/A (new program)

- Upcoming April Programs: Archery, Recording 101, Live Sound 101, Coach Pitch, T-Ball, Machine Pitch Baseball.
- Bachmann Construction is nearing completion of the staff restroom ahead of schedule. The space is coming together nicely, and the new wall provides an effective separation from the meeting room. A big thank you to Jeff and his team for completing the restroom painting to help save on project costs.
- Mount Horeb Lumber – Do It Best delivered the countertop and cabinets for the pool concession stand a few weeks ago. Jeff and his team are working on the installation, and it is looking really nice. We truly appreciate their efforts.
- We currently have approximately 50 programs that are at full capacity with active waiting lists, many of which are swim lessons. Additionally, we have introduced eight new programs for this summer.
- CeCe attended the WPRA Region III meeting at Madison College on April 17th. The event featured speakers from the U.S. Marine Corps Wellness and Recreation Division and the University of Wisconsin's Intramural Sports Department. They covered a variety of engaging topics, and CeCe had the opportunity to network with fellow recreation professionals from the region.
- We have hired on all of our head lifeguards for the pool this summer. Those who have been selected are: Payton Almquist (returning head lifeguard), Lily Beadle, Evan Green, and Piper McMahan. I am very excited for this team to get started and think they will do an excellent job.
- We have conducted a handful of in-person interviews for the Summer Office Assistant position and plan to complete a few more before making a final decision. It's encouraging to see a strong pool of candidates this year.

9. We are still in need of a Kids Camp Coordinator for the summer. Andrea plans to reach out to applicants who were not selected for an interview for the Summer Office Assistant position to gauge their interest in this role.
10. MOHOP utilized our porch area for their pickleball sign up event on April 9. They said the space worked out really well and expressed their appreciation for being able to use it.
11. We will begin selling WPRA discount attraction tickets in May. The following destinations are included: Noah's Ark, Land of Natura, Six Flags Great America, Mt. Olympus, and Milwaukee County Zoo.
12. Our Dick's Sporting Goods shop event will be held the weekend of May 2-5. Anyone can take advantage of the 20% off coupon in-store at the Madison West location. Our partnership with Dick's has been very strong and they will be giving us another gift card to use towards any needed equipment.



Village of Mount Horeb

Public Services Department

138 E Main St
Mount Horeb, WI 53572
Phone (608) 437-3351/Fax (608) 437-3190
www.mounthorebwi.info

Parks, Recreation and Forestry Commission

April 22, 2025

Public Services Director's Report

- The new Grundahl light poles have been installed by TLC Sign and the underground electric has also been installed by the Mt Horeb Utilities. E&S Electric is in the process of wiring the control panel, electric panel and the controls at each pole. We had to order some adapters for aluminum wire and they should arrive Wednesday or Thursday. We also ran a separate wire and installed an outlet near the batting cage so pitching machines could be plugged in. Our crew is in the process of cleaning up from the trenching and we will fill some ruts and do some seeding after we are done with stump removals.
- Installation of the new playground equipment at Grundahl Park is tentatively scheduled for early August. I listed our old playground equipment on Wisconsin Surplus and it sold for \$3,851. The buyer has until July 31 to remove all equipment and concrete.
- Our crew installed a 10'x16' bang board at the tennis and pickleball courts in March. The cost of the bangboard was \$5720 and was covered by MOHOP.
- We will be grinding 47 stumps the week of April 21.
- Our trees are scheduled to be delivered on May 1. We will be planting 38 trees. Most of the trees will be replacements for ash trees that were removed last winter.
- Badger Swimpools has been replacing tiles in the wading pool and plunge pool and repairing some poor concrete on the wall of the plunge pool. They finished the work on April 16.
- Our crew installed new cabinets and countertop in the pool concession room.
- We painted the exterior and interior walls of the new Rec Dept restroom.
- We opened the Sunrise restrooms on April 16 and plan to open Liberty and Waltz on April 17.

