



VILLAGE OF MOUNT HOREB

E. Main Street

Mount Horeb, WI 53572

Phone: (608) 437-6884 Fax: (608) 437-3190

Email: mhinfo@mounthorebwi.info Web: mounthorebwi.info

HISTORIC PRESERVATION COMMISSION AGENDA

Wednesday, April 22, 2026 at 6:00 PM

Municipal Building Board Room

138 E. Main Street

Mount Horeb, WI

- 1) Call to order
- 2) Public Comments on Non-Agenda Items*
- 3) Agenda Items
 - a. New Member Introduction
 - b. Consideration of February 25, 2026 Meeting Minutes
 - c. Recommendation of Certificate of Appropriateness Potterton Building at 105 E Main Street
 - d. Recommendation of Downtown Design Alteration Review for 101 E Main Street
 - e. Consideration of local designation for 312 S. 4th St.
- 4) Future agenda items
- 5) Meeting adjournment.

*Public Comment Policy

Members of the public are invited to speak at meetings of all Mount Horeb Public Bodies. To comment, please complete a Public Comment Form at the Meeting Room entrance and submit it to staff before the meeting begins. Comments are limited to **three minutes**, must be made from the podium, and the speaker must return to the audience after speaking.

- **Non-agenda item comments** are heard at the start of the meeting. Public Body members and staff will not engage in discussion during public comment but may consider topics for future agendas.
- **Agenda item comments** are heard during the relevant item, after the proposers or staff present the item and before Public Body discussion. All public comments on the item will be heard before any discussion by the Public Body.

Members of the public will only be allowed to speak outside these public comment times if they are invited by the meeting chair to share additional information requested by the Public Body. If so invited to speak, the member of the public must do so from the podium.

Written comments are also welcome. Written comments shall include the name and address of the submitter and should be submitted to the Deputy Treasurer/Governance Coordinator by email at niki.erickson@mounthorebwi.info (subject line: *Public Comment Request-Name of Public Body*) or delivered by to the Village at: 138 E Main Street, Mount Horeb WI, 53572, ATTN *Public Comment Request-Name of Public Body*.

UPON REASONABLE NOTICE, EFFORTS WILL BE MADE TO ACCOMMODATE THE NEEDS OF DISABLED

INDIVIDUALS THROUGH APPROPRIATE AIDS AND SERVICES. FOR INFORMATION OR TO REQUEST THIS SERVICE, CONTACT ALYSSA GAFFNEY, CLERK, AT 138 E MAIN STREET, MOUNT HOREB, WI (608) 437-9404.

Ethics Code

1. Statement of Purpose.

- (a) The proper operation of democratic government requires that public officials and employees be independent, impartial and responsible to the people; that government decisions and policy be made in proper channels of the governmental structure; that public office not be used for personal gain; and that the public have confidence in the integrity of its government. In recognition of these goals, there is hereby established in this Code of Ethics for all Village of Mount Horeb officials and employees, whether elected or appointed, paid or unpaid, including members of boards, committees and commissions of the Village, as well as any individuals who are candidates for elective office as soon as such individuals file nomination papers with the Village.
- (b) The purpose of this Ethics Code is to establish guidelines for ethical standards of conduct for all such officials and employees by setting forth those acts or actions that are incompatible with the best interests of the Village of Mount Horeb and by directing disclosure by such officials and employees of private financial or other interests in matters affecting the Village. The Village Board believes that a Code of Ethics for the guidance of elected and appointed officials and employees will help them avoid conflicts between their personal interests and their public responsibilities, will improve standards of public service and will promote and strengthen the faith and confidence of the citizens of this Village in their elected and appointed officials and employees. The Village Board hereby reaffirms that each elected and appointed Village official and employee holds his or her position as a public trust, and any intentional effort to realize substantial personal gain through official conduct is a violation of that trust. The provisions and purpose of this Ethics Code and such rules and regulations as may be established are hereby declared to be in the best interests of the Village of Mount Horeb.

2. Definitions.

The following definitions shall be applicable in this Chapter:

- (a) **Public Official.** Those persons serving in statutory elected or appointed offices provided for in Chapter 62 of the Wisconsin Statutes, and all members appointed to boards, committees and commissions established or appointed by the Village President and/or Village Board pursuant to this Code of Ordinances, whether paid or unpaid.
- (b) **Public Employee.** Any person excluded from the definition of a public official who is employed by the Village.
- (c) **Anything of Value.** Any gift, favor, loan, service or promise of future employment, but does not include reasonable fees and honorariums, or the exchange of seasonal, anniversary or customary gifts among relatives and friends.
- (d) **Business.** Means any corporation, partnership, proprietorship, firm, enterprise, franchise, association, organization, self-employed individual or any other legal entity which engages in profit-making activities.
- (e) **Personal Interest.** The following specific blood or marriage relationships:
 - (1) A person's spouse, mother, father, child, brother or sister; or
 - (2) A person's relative by blood or marriage who receives, directly or indirectly, more than one-half (½) support from such person or from whom such person receives, directly or indirectly, more than one-half (½) of his support.
- (f) **Significant Interest.** Owning or controlling, directly or indirectly, at least ten percent (10%) or Five Thousand Dollars (\$5,000.00) of the outstanding stock of at least ten percent (10%) or Five Thousand Dollars (\$5,000.00) of any business.

-
- (g) **Financial Interest.** Any interest which shall yield, directly or indirectly, a monetary or other material benefit to the officer or employee or to any person employing or retaining the services of the officer or employee.
 - (h) **Staff.** Any full- or part-time employee of the Village.

3. Statutory Standards of Conduct.

There are certain provisions of the Wisconsin Statutes which should, while not set forth herein, be considered an integral part of any Code of Ethics. Accordingly, the provisions of the following sections of the Wisconsin Statutes, as from time to time amended, are made a part of this Code of Ethics and shall apply to public officials and employees whenever applicable, to wit:

- (a) **Sec. 19.59.** State Ethics Law.
- (b) **Sec. 946.10.** Bribery of Public Officers and Employees.
- (c) **Sec. 946.11.** Special Privileges from Public Utilities.
- (d) **Sec. 946.12.** Misconduct in Public Office.
- (e) **Sec. 946.13.** Private Interest in Public Contract Prohibited.

4. Responsibility of Public Office.

Public officials and employees are agents of public purpose and hold office for the benefit of the public. They are bound to uphold the Constitution of the United States and the Constitution of this State and carry out impartially the laws of the nation, state and municipality, to observe in their official acts the highest standards of morality and to discharge faithfully the duties of their office regardless of personal considerations, recognizing that the public interest must be their prime concern. Their conduct in both their official and private affairs should be above reproach so as to foster respect for government.

5. Dedicated Service.

- (a) Officials and employees should adhere to the rules of work and performance established as the standard for their positions by the appropriate authority.
- (b) Officials and employees should not exceed their authority or breach the law or ask others to do so, and they should work in full cooperation with other public officials and employees unless prohibited from so doing by law or by officially recognized confidentiality of their work.
- (c) Members of the Village staff are expected to follow their appropriate professional code of ethics. Staff members shall file a copy of such professional ethics codes with the Village Clerk. The Village Clerk may notify the appropriate professional ethics board of any ethics violations involving Village employees covered by such professional standards.

6. Fair and Equal Treatment.

- (a) **Use of Public Property.** No official or employee shall use or permit the unauthorized use of Village-owned vehicles, equipment, materials or property for personal convenience or profit, except when such services are available to the public generally or are provided as Village policy for the use of such official or employee in the conduct of official business, as authorized by the Village Board or authorized board, commission or committee.
- (b) **Use of Village Stationery.** No official or employee shall use, or permit the unauthorized use of, Village stationery for personal use.

-
- (c) **Obligations to Citizens.** No official or employee shall grant any special consideration, treatment or advantage to any citizen beyond that which is available to every other citizen. No official or employee shall use or attempt to use his or her position with the Village to secure any advantage, preference or gain, over and above his rightful remuneration and benefits, for himself or for a member of his or her immediate family.
 - (d) **Political Contributions.** No official shall personally solicit from any Village employee, other than an elected official, a contribution to a political campaign committee for which the person subject to this Chapter is a candidate or treasurer.

7. Conflict of Interest.

(a) **Financial and Personal Interest Prohibited.**

- (1) No official or employee of the Village, whether paid or unpaid, shall engage in any business or transaction or shall act in regard to financial or other personal interest, direct or indirect, which is incompatible with the proper discharge of official duties in the public interest contrary to the provisions of this Chapter or which would tend to impair independence of judgment or action in the performance of official duties.
- (2) Any member of the Village Board who has a financial interest or personal interest in any proposed legislation before the Village Board shall disclose on the records of the Village Board the nature and extent of such interest; such official shall not participate in debate or vote for adoption or defeat of such legislation.
- (3) Any non-elected official who has a financial interest or personal interest in any proposed legislative action of the Village Board or any board, commission or committee upon which the official has any influence or input or of which the official is a member that is to make a recommendation or decision upon any item which is the subject of the proposed legislative action shall disclose on the records of the Village Board or the appropriate board, commission or committee the nature and extent of such interest. Such official shall not participate in debate or discussion or vote for adoption or defeat of such legislation.
- (4) Any Village employee who has a financial interest or personal interest in any proposed legislative action of the Village Board or any board, commission or committee upon which the employee has any influence of input, or of which the employee is a member, that is a make to recommendation or decision upon any item which is the subject of the proposed legislative action shall disclose on the records of the Village Board or the appropriate board, commission or committee the nature and extent of such interest.

- (b) **Disclosure of Confidential Information.** No official or employee shall, without proper legal authorization, disclose confidential information concerning the property, government or affairs of the Village, nor shall such information be used to advance the financial or other private interests of the official or employee or others.

(c) **Gifts and Favors.**

- (1) No official or employee, personally or through a member of his immediate family, may solicit or accept, either directly or indirectly, from any person or organization, money or anything of value if it could be expected to influence the employee's official actions or judgments or be considered a reward for any action or inaction on the part of the official or employee.
- (2) No official or employee personally, or through a member of his immediate family, shall accept any gift, whether in the form of money, service, loan, thing or promise, from any person which could reasonably be expected to impair his independence of judgment or action in the performance of his duties or grant in the discharge of his duties any improper favor, service or thing of value. However, it is not a conflict of interest for any public official or employee to receive hospitality that is unsolicited and unrelated to government business, such as a meal, and that is not intended to influence the official.

-
- (3) An official or employee is not to accept hospitality if, after consideration of the surrounding circumstances, it could reasonably be concluded that such hospitality would not be extended were it not for the fact that the guest, or a member of the guest's immediate family, was a Village official or employee. Participation in celebrations, grand openings, open houses, informational meetings and similar events are excluded from this prohibition. This paragraph further shall not be construed to prevent candidates for elective office from accepting hospitality, as a properly reported political contribution, from citizens for the purpose of supporting the candidate's campaign. (The State Ethics Board has interpreted "hospitality" as it applies to state officials as including meals, beverages and lodging which a person offers at his residence and would have been offered if the recipient was not an official).
 - (4) Gifts received by an official or employee or his immediate family under unusual circumstances shall be referred to the Village Board within ten (10) days of receipt for recommended disposition. Any person subject to this Chapter who becomes aware that he is or has been offered any gift, the acceptance of which would constitute a violation of this Subsection, shall, within ten (10) days, disclose the details surrounding said offer to the Village Board. Failure to comply with this reporting requirement shall constitute an offense under this Chapter.
- (d) **Representing Private Interests Before Village Agencies or Courts.**
- (1) Non-elected Village officials and employees shall not appear on behalf of any private person (other than him or herself, his or her spouse or minor children) before any Village agency, board, commission or the Village Board if the official or employee or any board, commission or committee of which the official or employee is a member has any jurisdiction, discretion or control over the matter which is the subject of such representation.
 - (2) Elected Village officials may appear before Village agencies on behalf of constituents in the course of their duties as representatives of the electorate or in the performance of public or civic obligations. However, the disclosure requirements of Subsection (a) above shall be applicable to such appearances.
- (e) **Ad Hoc Committee Exceptions.** No violation of the conflict-of-interest restrictions of this Section shall exist, however, where an individual serves on a special ad hoc committee charged with the narrow responsibility of addressing a specific issue or topic in which that individual, or the employer or a client of that individual, has an interest so long as the individual discloses to the Village Board that such interest exists.
- (f) **Contracts with the Village.** No Village official or employee who, in their capacity as such officer or employee, participates in the making of a contract in which he has a private pecuniary interest, direct or indirect, or performs in regard to that contract with some function requiring the exercise of discretion on his part shall enter into any contract with the Village unless, within the confines of Sec. 946.13, Wis. Stats.:
- (1) The contract is awarded through a process of public notice and competitive bidding or the Village Board waives the requirement of this Section after determining that it is in the best interest of the Village to do so.
 - (2) The provisions of this Subsection shall not apply to the designation of a public depository of public funds.

8. Advisory Opinions.

When an official or employee has doubt as to the applicability of a provision of this Ethics Code to a particular situation or definition of terms used in this Chapter, he should apply to the Village Administrator for an advisory opinion from the Village Attorney and will be guided by that opinion when given. The official or employee shall have the opportunity to present his interpretation of the facts at issue and of the applicability provisions of this Chapter before such advisory decision is made. This Chapter shall be operative in all instances covered by its provisions except when superseded by an applicable statutory provision and statutory action is mandatory, or when the application of a statutory provision is discretionary, but determined by the Village Attorney to be more

appropriate or desirable. Advisory requests and opinions shall be kept confidential, except when disclosure is authorized by the requestor, in which case the request and opinion may be made public.

9. Hiring Relatives.

- (a) This Section governs the proposed hiring of individuals for full-time or part-time work as Village employees who are members of the immediate family of Village employees or elected officials. "Immediate family" includes those relatives by blood or marriage defined in Section 2(e) as personal interests.
- (b) Hiring an immediate family member of any current Village employee or elected Village official will be considered only if that individual has the knowledge and skills, experience or other job-related qualifications that warrant consideration for the position. A person cannot be hired for either full-time or part-time employment in a position immediately supervised by a member of that person's immediate family.
- (c) This Section does not apply to non-elected officials who are asked to accept appointment as members of a Village Board, commission or committee; non-elected officials, however, will be expected to disqualify themselves from participation in matters under consideration which may affect the hiring, retention, classification or compensation of their immediate family if currently employed or being considered for employment by the Village.

10. Employees Covered by Collective Bargaining Agreements.

In the event an employee, covered under a collective bargaining agreement, is allegedly involved in an Ethics Code violation, the terms and conditions set forth in the applicable collective bargaining agreement shall prevail in the administration and interpretation of this Ethics Code Chapter.

11. Employee Protection.

No appointing authority, agent of an appointing authority or supervisor may initiate or administer, or threaten to initiate or administer, any retaliatory action against a Village employee following an employee's disclosure of information related to the violation of any federal or state law, rule or regulation, the mismanagement or abuse of authority, a substantial waste of public funds, or a danger to public health and safety. Nothing in this Section restricts the right of the Village as an employer to take appropriate disciplinary action against an employee who knowingly makes an untrue statement or discloses information, the disclosure of which is specifically prohibited by federal or state law, rule or regulation.



AGENDA ITEM REPORT

MEETING DATE

April 22, 2026

PREPARED BY

AGENDA ITEM # 3.b

Consideration of February 25, 2026 Meeting Minutes

BACKGROUND

RECOMMENDATION

ATTACHMENTS

1. Draft Minutes 02 25 26

HISTORIC PRESERVATION COMMISSION AGENDA
Wednesday, February 25, 2026 at 6:00 PM

DRAFT MEETING MINUTES

1) Call to order

Chair Marc Schellpfeffer called the meeting to order at 6:00 pm in the Board Room of the Municipal Building, 138 East Main Street, Mount Horeb, WI.

Members Present: Megan Minter, Maura Overland, Destinee Udelhoven

Members Absent: Jackie Sale

Others Present: Village Administrator Nic Owen, Assistant Clerk Jean Culberson

2) Public Comments on Non-Agenda Items

No Comments.

3) Agenda Items

a. Consideration of January 21, 2026 Meeting Minutes

Udelhoven Motioned and Minter seconded to approve the January 21, 2026 meeting minutes. Motion carried by unanimous voice vote.

b. Review Historic Designation Plaque Options

Udelhoven presented two plaques for review. The Commission selected the 5X7 plaque with the bronze lettering and black background. The Building Department will be in charge of ordering the plaque and the property owner will be responsible for placing it on the property. Udelhoven to confirm wording on the plaque.

Schellpfeffer Motioned and Minter seconded to approve the 5 X 7 bronze black plaque. Motion carried by unanimous voice vote.

c. Discussion on Historic Survey Public Introduction Meeting

Udelhoven summarized the meeting and the topics to discuss.

d. Final Thoughts on Downtown Zoning District and Local Register Sections of Zoning Code rewrite

The Commission discussed the following draft code and recommended:

- Page 167 - remove the three current color palettes and adopt the Sherwin Williams Historic Paint Color palettes by Era. Applicants may choose their paint color choice within the era. New construction paint colors should complement surrounding structures. HPC recommendation and Plan Commission approval is required for black or colors not following the palettes. Signs are not required to follow the color palettes.
- Page 167 - remove the vinyl siding wording.
- Stepback removed for Main Street as long as there is articulation.
- Front setback of 50' or 40% for commercial use in the Downtown Mixed Use. Udelhoven Motioned to maintain the 50' for commercial and Overland seconded. Motion carried by voice vote with exception to Schellpfeffer who objected.
- Historic concern for review of lot consolidation within and adjacent to properties on the registered.
- HPC design review over projects that are occurring directly or adjacent to the Historic District or structure.

- Properties not wanting to be designated are allowed to appeal.

4) Future agenda items

HPC Awards

Review the Public Meeting.

5) Meeting adjournment.

Minter Motioned, Overland seconded to Meeting adjournment at 6:57pm. Motion carried by unanimous voice vote.

Minutes by Assistant Clerk Jean Culberson



VILLAGE OF MOUNT HOREB
 Zoning Administrator 608-437-9409
 138 East Main Street
 Mount Horeb, WI 53572

PLAN COMMISSION APPLICATION

PROJECT NAME: 105 E. Main St

Project Address 105 E. main St **Parcel Number:** 0606-123-2207-5

[Access Dane Link](#)

Zoning Map

Current Zoning CB at the time of request **Future Land Use Zoning:** _____
 ([select zoning layer in map](#)) ([select future land use layer in map](#))

APPLICANT: <u>KERIC POTTERTON</u>	
ADDRESS: <u>900 High Point Road Dodgeville</u>	
PHONE: <u>608-574-7045</u>	EMAIL: <u>kpotterton@pottertonrule.com</u>

OWNER:	
ADDRESS:	
PHONE:	EMAIL:

PROJECT DESCRIPTION: Painting trim black, including trim around front windows, siding above large front windows & doors, curb & upper window trim on alley side windows, paint brick under large window white to match upper brick

OWNER/APPLICANT SIGNATURE:  **DATE:** 7 April 2026

FEES & DEPOSITS: (CHECK ALL THAT APPLY)

Application	Fee	Public Hearing-	Developer Deposit: An escrow deposit is required in accordance with the Development Application Agreement. Total Fee Paid: _____ Date: _____ Fee Waived By: _____
<input checked="" type="checkbox"/> Certificate of Appropriateness (for Central Business Zoning)	No Fee		
<input type="checkbox"/> Certified Survey Map (CSM) <i>scroll to Section 18.61 in schedule</i>	Schedule		
<input type="checkbox"/> Certified Survey Map Extraterritorial <i>scroll to Section 18.61 in schedule</i>	Schedule		
<input type="checkbox"/> Comprehensive Plan Amendment	\$150.00	Class One	
<input type="checkbox"/> Conditional Use Permit (changes in USE of property)	\$150.00	Class Two	
<input type="checkbox"/> Conditional Use Permit (planned development district)	\$200.00	Class Two	
<input type="checkbox"/> Design Review	\$100.00		
<input type="checkbox"/> General Development Plan (GDP)	\$200.00		
<input type="checkbox"/> Specific Improvement Plan (SIP)	\$300.00		
<input type="checkbox"/> Zoning Amendment (changes in zoning)	\$150.00	Class Two	
<input type="checkbox"/> Zoning Amendment (planned development district)	\$200.00	Class Two	

My request is to paint what is currently blue to black. So, the siding above the big windows, both doors, the curb and the trim around the upper window in front and also in the alley side. The brick under the front large windows would go to white to make the brick above the front windows. Also, the cement panel -that says BANK and the year will be highlighted in black.



Stone Marker





VILLAGE OF MOUNT HOREB
 Zoning Administrator 608-437-9409
 138 East Main Street
 Mount Horeb, WI 53572

PLAN COMMISSION APPLICATION

PROJECT NAME: Hoff Mall & Hoff Apartments - Exterior Updates

Project Address 101 E Main & 100 E Front Streets **Parcel Number:** NA
[Access Dane Link](#)

Zoning Map

Current Zoning DMU **Future Land Use Zoning:** NA
[\(select zoning layer in map\)](#) [\(select future land use layer in map\)](#)

APPLICANT: Karen Johnson for Hoff Associates of Mt. Horeb, LLP	
ADDRESS: 101 E. Main Street, Suite 500 - Mount Horeb, WI 53572	
PHONE: 608-237-1300	EMAIL: kjohnson@gallinacos.com

OWNER: Hoff Associates of Mt. Horeb, LLP	
ADDRESS: 101 E. Main Street, Suite 500 - Mount Horeb, WI 53572	
PHONE: 608-237-1300	EMAIL: kjohnson@gallinacos.com

PROJECT DESCRIPTION: Replace existing awnings on E. Main Street, S. First Street and E. Front Street with fabric that is black with gold stripes, paint window frames around apartments on 2nd floor of Hoff Mall Building, tuck pointing of Hoff Mall Building

OWNER/APPLICANT SIGNATURE: **DATE:** 4/17/26

FEES & DEPOSITS: (CHECK ALL THAT APPLY)

Application	Fee	Public Hearing-
<input type="checkbox"/> Certified Survey Map (CSM) <i>scroll to Section 18.61 in schedule</i>	Schedule	
<input type="checkbox"/> Certified Survey Map Extraterritorial <i>scroll to Section 18.61 in schedule</i>	Schedule	
<input type="checkbox"/> Comprehensive Plan Amendment	\$150.00	Class One
<input type="checkbox"/> Conditional Use Permit (changes in USE of property)	\$150.00	Class Two
<input type="checkbox"/> Conditional Use Permit (planned development district)	\$200.00	Class Two
<input checked="" type="checkbox"/> Design Review	\$100.00	
<input type="checkbox"/> General Development Plan (GDP)	\$200.00	
<input type="checkbox"/> Specific Improvement Plan (SIP)	\$300.00	
<input type="checkbox"/> Zoning Amendment (changes in zoning)	\$150.00	Class Two
<input type="checkbox"/> Zoning Amendment (planned development district)	\$200.00	Class Two

Developer Deposit:
 An escrow deposit is required in accordance with the Development Application Agreement.
Total Fee Paid: _____
Date: _____
Fee Waived By: _____



proposed



existing



- Replace awnings to give the building a fresh look - fabric sample is attached (black with gold stripes). The apron along the bottom of these would be black. (We are also planning on replacing all of the awnings on the apartment building at 100 E. Front Street – Zoned PUD)
- Paint the window frames on 2nd floor of the Hoff Mall Building to black so these also maintain the same blending with the building and awnings.

New signage permit approved 4/16/26



Proposed -Hoff Mall along 1st Street



PUD Zoning-Existing Apartment building – Front & First Street

Replacing awnings



HERITAGE
COMMUNITY
OPPORTUNITY

VILLAGE OF MOUNT HOREB

138 E. Main Street
Mount Horeb, WI 53572
Phone: (608) 437-6884 Fax: (608) 437-3190
Email: mhinfo@mounthorebwi.info Web: mounthorebwi.info

**Village of Mount Horeb Municipal Register of Historic Places
Nomination Form for Structures, Sites or Entities**

NOTE: Please complete this form to the best of your ability. Attach additional sheets as needed, clearly referencing the associated number(s) on the Nomination Form. Village staff or Commission members may request additional information to enable a thorough evaluation. To ensure necessary review time, completed forms are due at least 30 days prior to a regularly scheduled Village of Mount Horeb Historic Preservation Commission meeting.

1. Form prepared by: _____ Date 4-4-2026
Name Ryan Stowe + Megan Varnum
Address 312 S 4th St
City, State, Zip Code Mount Horeb, WI, 53572
Telephone (517) 745-1440
Email rlstowe@icloud.com

2. Owner (if different than above)
Name _____
Address _____
City, State, Zip Code _____
Telephone _____
Email _____

3. What is the historic name of this property? Dahle, Henry L. + Sarah, House

4. What is the current name of this property? N/A

5. Where is the property located?
Address (street and number) 312 South Fourth Street
Legal Description _____

Tax Parcel Number 157/0606-123-6629-7

6. Provide physical description of exterior and the state of its current condition.

See Section 7 pp. 1-5 with the following amendments:
- The foundation is concrete blocks, not poured concrete
- Two cast-iron railings flank both sides of the front stairs

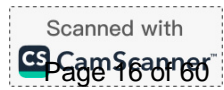



7. Do you know any of the following information?

The architect's name was Claude + Starck

The builder's name was _____

The date of construction was 1916

8. If a structure or entity, are you aware of any changes to the original fabric? Please check one or more boxes, as applicable.

- additions
- replacement siding or re-siding
- removal of porches
- removal of decorative details
- replacement doors and/or windows
- interior remodeling or updating
- moved from its original location (if moved, list why, from where and when in description below)

Briefly describe any changes checked above:

- A 3-car garage was added ~ 2000. This was clad in brick to match the house
- A second floor bathroom was remodeled in 2017
- The kitchen was remodeled ~ 2006

9. Significance of the property

Period(s)	Area(s) of Significance (check all that apply, and justify below)				
Prehistoric	Archeology-prehistoric	Community planning	Landscape Architecture	Religion	
1400-1499	Archeology-historic	Conservation	Law	Science	
1500-1599	Agriculture	Economics	Literature	Sculpture	
1600-1699	<input checked="" type="checkbox"/> Architecture	Education	Medicine	Social	
1700-1799	Art	Engineering	Military	Humanitarian	
1800-1899	Commerce	Exploration/settlement	Music	Theatre	
<input checked="" type="checkbox"/> 1900-1950	Communications	<input checked="" type="checkbox"/> Historic personages	Native American life	Trails	
19--	*	Industry	Philosophy	Transportation	
20--		Invention	Politics/government	Other (specify)*	

Why do you think that this property should be listed in the Municipal Register? In one or two paragraphs, summarize its importance in the context of the Mount Horeb area story.

See Section 8 pp. 1-8 of the appended documents for details

- This property is an exemplar of Madison architect Claude + Starck's Prairie School residences
- This property was designed for a member of one of Mt. Horeb's most prominent families, the Dahle family



HERITAGE
COMMUNITY
OPPORTUNITY

VILLAGE OF MOUNT HOREB

138 E. Main Street
Mount Horeb, WI 53572
Phone: (608) 437-6884 Fax: (608) 437-3190
Email: mhinfo@mounthorebwi.info Web: mounthorebwi.info

(cont.)

10. What is known about the history of the property?

Detailed in Section 8, pp. 1-5 of the attached document

11. Reference list. For statements of fact, list sources of information. Attach photocopies when feasible.

Source	<u>Henry + Sarah Dahl House NRHP app</u>	Page	_____
Source	<u>0</u>	Page	_____
Source	_____	Page	_____

12. Attachments

o **Photographs***

Please submit clear, recent photographs that show all sides of the exterior of the structure. Interior views of structures that highlight the construction, fabric and integrity are helpful, but not required. For properties with more than one building (i.e. farmsteads, industrial complexes or religious complexes), include photographs of all buildings and structures that make up the complex. **Submitted photographs will become a permanent part of the site record, and will NOT be returned.**

**For additional direction regarding preferred photograph composition and submission format, see page 5, "Photograph Information Sheet."*

o **Map**

Submit a copy of the parcel map from Dane County's online land records system, found at <https://accessdane.danecounty.gov/Parcel>.

For properties with more than one building, photographs of the outbuildings should be keyed to this parcel map in order to indicate the relative relationship of the components. Please also indicate the location of any known former buildings, if they once were part of the complex. When possible, dates should be provided for all buildings.

o **Photocopies of historic photographs**

While not required, historic photographs can be useful in evaluating changes to the property. When available, please provide photocopies of historic images, listing the source and date of the photograph. **DO NOT SEND ORIGINALS.**

Complete and return this form, along with recent photos and any additional attachments, to:

Historic Preservation Commission
Village of Mount Horeb
138 E Main Street
Mount Horeb WI 53572

COMMISSION ACTIONS (Applicant leave blank; for Commission use only.)

Committee hearing date _____

Committee recommendation (including brief justification) _____

Signature of Commission Chair _____ Date _____



Photograph Information Sheet

Photo composition

- Photos should be recent and clear.
- If you are using a digital or phone camera, set to the highest quality possible.
- Stand back far enough that you can see the whole building from top to bottom in one photo.
- Photograph each side of the structure.
- Interior photos, while not required, are also very helpful. Documentation of defining features (i.e. fireplaces, staircases, built-in furniture, decorative trim) can be illustrative of building techniques, architecture styles and historical integrity. It is not necessary to photograph every room.
- If there are multiple buildings on the property (as with farmsteads or a church campus), please photograph each building separately. Include a parcel map from Dane County's online land records system, found at <https://accessdane.danecounty.gov/Parcel>, and key the photographs to this map.

Photo submission

- Submit a set of standard size prints, commercially-produced or printed at a store.

OR

- Save your photos to a flash drive, and submit the flash drive and print-outs of each photo.
 - Save the images to the flash drive as a high quality jpeg. Use the file name to describe the photo (i.e. "front of house", "back of barn", "second floor staircase main house").
 - DO NOT crop or resize the images prior to saving them to the flash drive.
 - Remember to include a hard copy of the photos. These print-outs can be made on a home printer using regular printer paper.

Parcel Number - 157/0606-123-6629-7

Current

Summary Report

< Parcel Parents

Parcel Summary

More +

Municipality Name	VILLAGE OF MOUNT HOREB
Parcel Description	LINGARD'S ADDN BLOCK 7 E 135 FT LOT 9, E...
Owner Names	
Primary Address	312 S FOURTH ST
Billing Address	312 S 4TH ST MOUNT HOREB WI 53572

Show Municipal Contact Information

Assessment Summary

More +

Assessment Year	2025
Valuation Classification	G1
Assessment Acres	0.420
Land Value	\$93,900.00
Improved Value	\$493,400.00
Total Value	\$587,300.00

Show Valuation Breakout

Zoning Information

For the most current and complete zoning information contact:
[Village of Mount Horeb](#) | 608-437-6884

District Information

Type	State Code	Description
REGULAR SCHOOL	3794	MOUNT HOREB SCHOOL DIST
TECHNICAL COLLEGE	0400	MADISON TECH COLLEGE

Parcel Maps



Esri, NASA, NGA, USGS, FEMA | Esri Community Maps Contributors, County of Dan... Powered by Esri

DCIMap

Google Map

Bing Map

Tax Information

E-Statement

E-Bill

E-Receipt

Pay Taxes Online

<< < Newer Older >>

Tax Year 2025		
Assessed Land Value	Assessed Improvement Value	Total Assessed Value
\$93,900.00	\$493,400.00	\$587,300.00
Taxes:		\$10,480.27
Lottery Credit(-):		\$228.52
First Dollar Credit(-):		\$76.17
Specials(+):		\$0.00
Amount:		\$10,175.58
2025 Tax Info Details		Tax Payment History

Recorded Documents

Doc. Type	Date Recorded	Doc. Number	Volume	Page
D	11/01/2024	5994184		
QCD	12/05/2019	5546369		
WD	08/16/2016	5259519		
TDI	05/16/2016	5234623		
WD	08/04/1999	3141586		
WD	11/17/1997	2907539		
QCD	11/17/1997	2907538		
WD	08/21/1990	2218031	14608	79

List of Attachments:

Henry and Sarah Dahle House National Register of Historic Places Registration Form

Southeast view of house, taken 2026

South view of house, taken 2026

South view of house 2, taken 2026

Northeast view of house, taken 2026

North view of house, taken 2026

North view of house 2, taken 2026

South view of garage, taken 2026

North view of garage, taken 2026

East view of the house, taken 2026

East view of the house 2, taken 2026

Coat closet, taken 2024

Foyer, taken 2026

Fireplace, taken 2024

Dining room built-in, taken 2024

Main stairway, taken 2026

**United States Department of Interior
National Park Service**

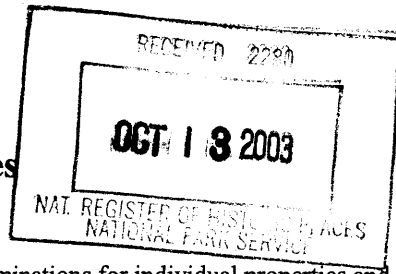

**National Register of Historic Places
Registration Form**

This form is for use in nominating or requesting determinations for individual properties and districts. See instructions in *How to Complete the National Register of Historic Places Registration Form* (National Register Bulletin 16A). Complete each item by marking "x" in the appropriate box or by entering the information requested. If an item does not apply to the property being documented, enter "N/A" for "not applicable." For functions, architectural classification, materials, and areas of significance, enter only categories and subcategories from the instructions. Place additional entries and narrative items on continuation sheets (NPS Form 10-900A). Use a typewriter, word processor, or computer, to complete all items.

1. Name of Property

historic name Dahle, Henry L. and Sarah, House

other names/site number N/A

2. Location

street & number	312 South Fourth Street	N/A	not for publication
city or town	Mount Horeb	N/A	vicinity
state Wisconsin	code WI	county Dane	code 025 zip code 53572

3. State/Federal Agency Certification

As the designated authority under the National Historic Preservation Act, as amended, I hereby certify that this nomination request for determination of eligibility meets the documentation standards for registering properties in the National Register of Historic Places and meets the procedural and professional requirements set forth in 36 CFR Part 60. In my opinion, the property meets _ does not meet the National Register criteria. I recommend that this property be considered significant _ nationally statewide locally. (_ See continuation sheet for additional comments.)

Alvina L. Cori
Signature of certifying official/Title

October 9, 2003
Date

State Historic Preservation Officer-WI

State or Federal agency and bureau

In my opinion, the property _ meets _ does not meet the National Register criteria.
(_ See continuation sheet for additional comments.)

Signature of commenting official/Title

Date

State or Federal agency and bureau

Dahle, Henry L. and Sarah, House
Name of Property

Dane
County and State

Wisconsin

4. National Park Service Certification

- I hereby certify that the property is:
- entered in the National Register.
___ See continuation sheet.
 - determined eligible for the National Register.
___ See continuation sheet.
 - determined not eligible for the National Register.
___ See continuation sheet.
 - removed from the National Register.
 - other, (explain):

Roll Boland

11/26/03

Signature of the Keeper

Date of Action

5. Classification

Ownership of Property (check as many boxes as apply)	Category of Property (Check only one box)	Number of Resources within Property (Do not include previously listed resources in the count)	
		contributing	noncontributing
<input checked="" type="checkbox"/> private	<input checked="" type="checkbox"/> building(s)		
<input type="checkbox"/> public-local	district	1	buildings
<input type="checkbox"/> public-State	structure		sites
<input type="checkbox"/> public-Federal	site		structures
	object		objects
		1	0 total

Name of related multiple property listing:
(Enter "N/A" if property not part of a multiple property listing.)
N/A

Number of contributing resources
is previously listed in the National Register
0

6. Function or Use

Historic Functions
(Enter categories from instructions)

Current Functions
(Enter categories from instructions)

DOMESTIC/single dwelling

DOMESTIC/single dwelling

7. Description

Architectural Classification
(Enter categories from instructions)
Prairie School

Materials
(Enter categories from instructions)
Foundation Concrete

walls Brick

Stucco

roof Ceramic Tile

other Wood

Narrative Description

(Describe the historic and current condition of the property on one or more continuation sheets.)

**United States Department of the Interior
National Park Service**

**National Register of Historic Places
Continuation Sheet**

Section 7 Page 1

Dahle, Henry L. and Sarah, House
Mount Horeb, Dane Co., WI

The Henry L. and Sarah Dahle house is a large, exceptionally fine and highly intact Prairie School style single family residence. It is set well back on a triple lot parcel that occupies the NW corner created by the intersection of Fourth and Academy streets in the city of Mount Horeb, which is located approximately seventeen miles west of the city of Madison, Wisconsin's capitol.¹ This flat, well-landscaped parcel occupies one of the highest points in Mt. Horeb, and although the house is now and has long since been surrounded by other single family residences, its second story still enjoys panoramic views of the surrounding neighborhood and points beyond. The two-story, L-plan Dahle house was designed by Claude & Starck, a Madison architectural firm that produced numerous excellent Prairie School style buildings between 1900 and 1920. Their Dahle house has poured concrete foundation walls that enclose a full basement story, exterior walls that are clad in dark brown brick, and main gable ends that are clad in painted stucco. These walls are sheltered by extremely wide overhanging eaves that have stucco-covered soffits ornamented with wood trim laid in parallel strips, while the multi-gable main roof features inset rain gutters and is clad with green colored ceramic tiles. Windows throughout the house are original and consist of grouped one-over-one-light, double hung wood sash that are still protected by their original one-over-one-light storm windows. In addition, the house also possesses one of Claude & Starck's most outstanding and intact interiors.

The nearly square parcel of land that belongs to the Dahle house is located in a predominantly late nineteenth-early twentieth century residential neighborhood situated on a shallow hill that overlooks the historic downtown portion of the city, located three blocks to the north of the house, and the hills beyond the city. The front of this parcel faces east onto the north/south-running Fourth Street. This is a quiet residential thoroughfare whose south end terminates one block south of its intersection with the east/west-running Academy Street, which thoroughfare forms the south side of the Dahle house parcel. The Dahle house parcel is landscaped with shrubs, mature trees and lawn, and it is edged with concrete sidewalks and gutters. Nearly all the other lots in the surrounding area also contain single family dwellings dating from the 1880s to the 1930s, most of which still retain a good degree of integrity. The principal exception to the houses is the Prairie School style Mt. Horeb Public School building, which faces onto Academy Street one block west of the Dahle house and which was also designed by Claude & Starck and begun by them in 1917, the year in which the Dahle house was finished.

Exterior

Except for the main gable ends, which are clad in stucco, all the exterior walls of the house are clad in dark brown brick. This brick is laid in stretcher bond, begins at ground level, and continues up to the

¹ The population of Mount Horeb was 4182 in 2000.

**United States Department of the Interior
National Park Service**

**National Register of Historic Places
Continuation Sheet**

Section 7 Page 2

Dahle, Henry L. and Sarah, House
Mount Horeb, Dane Co., WI

broad wood cornice that encircles the house at the base of the eaves, the wall expanse being interrupted only by a dressed stone beltcourse that encircles the house at the level of the first story window sills.

The main facade of the house faces east onto Fourth Street and it is symmetrical in design and three-bays-wide. Both the first and third bays of this facade are identical in design. Each bay consists of two small oblong windows in the raised basement story, a triple window group in the first story made up of three equal size one-over-one-light double hung wood sash windows, and a double window group in the second story made up of two wider one-over-one-light double hung wood sash windows. The sills of the first story windows are formed by the previously mentioned stone beltcourse and the sills of the second story also have sills made of the same stone.

The focal point of this facade is a wide, centrally positioned two-story gable-roofed bay whose first story contains the main entrance of the house. Helping to define this bay are two massive, projecting, full height brick buttresses that delineate its outside edges and help support the stucco-clad gable end that crowns and shelters it. The main entrance is centered on the first story of this bay and it is reached by ascending a wide flight of seven wooden steps that are flanked on both sides by stepped brick-clad wing walls that are topped with dressed stone slabs. A deck that is floored in wood and encircled with a solid brick balustrade capped with dressed stone is placed at the top of these steps and it is sheltered by a large overhanging wooden balcony placed above it that is supported by four massive wood brackets. The flat underside of this balcony is covered in plaster and the balcony itself is encircled by a heavy wooden balustrade made of scrollsawn boards. Three separate one-over-one-light double hung wood sash windows look out onto this balcony from the second story of the facade and the placement of these windows is echoed in the design of the three elements found in the first story just below. These first-story elements consists of a massive oak entrance door in the center that is flanked on either side by small deeply inset double hung one-over-one-light wood sash windows whose lights are each themselves enframed with a band of smaller milk-white art glass lights.² Separating each of these three elements from the others are two massive, one-story-tall projecting brick piers of the same dimensions as the two-story buttresses that edge the bay, and it is against these four projecting masses that the four brackets that support the balcony rest.

Sheltering the main facade are the very wide overhanging eaves of the main roof. The soffits of these eaves are clad in stucco and their length is divided into three equal-width sections by thin wood strips that run the length of the eaves. Rain gutters are inset into the eaves and the entire roof, the ridgeline of which runs north/south, is clad in flat, deeply grooved ceramic tiles of the type that are sometimes

² A segmental-arched plate glass light is placed in the upper half of the entrance door and it has the letter "D" etched into it.

**United States Department of the Interior
National Park Service**

**National Register of Historic Places
Continuation Sheet**

Section 7 Page 3

Dahle, Henry L. and Sarah, House
Mount Horeb, Dane Co., WI

called "French Tiles," these particular examples being glazed in a green color that resembles a copper patina.

The pronounced horizontality of the main facade is further emphasized by the addition of the east end of a one-story, shed-roofed open porch that spans nearly the entire width of the first story of the symmetrically designed south-facing side elevation of the house. The elements of this porch were constructed using the same brick as the rest of the house and they consist of a solid balustrade that encircles the three sides of the porch and whose upper surface is protected by dressed stone slabs that form an extension of the beltcourse that encircles the main block of the house. The porch roof is supported at its corners by two one-story brick piers of the same dimensions as the buttresses that edge the main facade's entrance bay. These piers are doubled by deep buttresses of the same width that are placed on the south-facing elevations main wall surface and the two ends of the tile-clad shed roof that they support are hidden by solid brick balustrades that are also topped by dressed stone slabs. The floor of the porch is comprised of painted wood tongue-and-groove boards, the ceiling is plastered, and a flight of six steps flanked by brick wing walls that are topped with dressed stone slabs provides an exit to ground level at the west end of the porch.

Sheltered by this porch and centered on the first story of the brick-clad main wall surface of the south-facing elevation is a large flat-arched opening that contains three double hung one-over-one-light wood sash windows and a wood door that contains a large, nearly full-length single light. The windows and door all provide light for the living room inside and the door also provides the only access to the porch from inside the house. The two ends of the second story above are defined by broad brick-clad buttresses that are placed directly above the ones on the first story below and this story features two nearly square window openings that both have dressed stone sills and contain double hung one-over-one-light wood sash windows. The full-width gable end above is clad in painted stucco and centered on it is a window group that contains two double hung one-over-one-light wood sash windows.

The west-facing rear elevation of the house is asymmetrical in design and it was originally dominated by a still extant brick-clad, two-story gable-roofed wing that projects from the north end of the elevation and which contains an enclosed rear entrance porch in its first story and a sleeping porch in its second story. The first story of this wing is now hidden by a modern garage wing that is described below. The three sides of the second story consist of groups of casement windows, five on the north and south sides and ten across the west-facing side. Like the second story of the south-facing side elevation described above, the edges of the second story of the west-facing elevation of this wing are also defined by brick buttresses and the wing is also crowned by a stucco-clad gable end, although this one contains just a single double hung one-over-one-light wood sash window.

United States Department of the Interior
National Park Service

National Register of Historic Places
Continuation Sheet

Section 7 Page 4

Dahle, Henry L. and Sarah, House
Mount Horeb, Dane Co., WI

The remaining portion of the west-facing elevation is wider than the sleeping porch wing and it is asymmetrical in design. The first story is two-bays-wide and the left-hand bay consists of a triple window group of double hung one-over-one-light wood sash windows that light the dining room. The right-hand bay consists of two identical windows that help light the living room and which are placed on either side of a broad, projecting, two-story-tall chimney mass that services the living room fireplace. The elevation's second story consists of a small double hung one-over-one-light wood sash window to the left that lights the principal second story bathroom and placed to its right is a polygonal oriel bay that is positioned so as to cover the left half of the second story of the chimney mass, the upper portion of which pierces the main roof. This bay lights a second story bedroom and it has stucco-clad spandrels placed below three double hung one-over-one-light wood sash windows.

Attached to the first story of the sleeping porch wing is a three-year-old rectilinear plan, three-car garage wing that is the only major change that has occurred to the exterior of the house since it was built. When the current owners purchased the house, the previous owners had already begun but not finished the construction of this one-story shed-roofed wing, which they had intended to cover in aluminum clapboard.³ Realizing that this would be out of keeping with the design of the original house, the current owners decided to cover the garage in brick and then began an extensive search to find brick that matched that used on the house. They also decided to continue the dressed limestone beltcourse that ornaments and encircles the house around the garage as well in order to make the new wing as complimentary as possible with the house. The resulting wing is now a quite successful match for the house.

The north-facing side elevation of the house consists of two parts, the side of the main block of the house and the narrower north-facing elevation of the two-story sleeping porch wing. The porch wing is to the right (west) and is one-bay-wide. The first story of this wing was the original rear entrance porch of the house and the bay contains a single large rectangular opening that was originally filled with screening. This opening has now, however, been partially filled with wood and two modern one-over-one light metal frame double hung windows have been inserted into it, this being the only other change that has occurred to the exterior of the house aside from the garage wing. The wing's second story consists of a second large opening that is filled with five wood sash one-light casement windows, the sills of which consist of a dressed limestone stringcourse that is identical to the belt course that forms the sill of the first story opening. The side elevation of the main block is very nearly symmetrical in design and is three bays wide. The first story contains two pairs of double hung one-

³ The downward slope of the garage roof is to the north and the ends are hidden by the upper portions of the garage's side walls, which are crowned with a dressed limestone stone cap of the same width as the beltcourse.

United States Department of the Interior
National Park Service

National Register of Historic Places
Continuation Sheet

Section 7 Page 5

Dahle, Henry L. and Sarah, House
Mount Horeb, Dane Co., WI

over-one-light wood sash windows. The pair on the left (east) are taller and provide light to the music room while the shorter pair to the right provide light to the kitchen. The second story contains two identical double hung one-over-one-light wood sash windows that provide light for bedrooms and a smaller window of identical design is placed between them. Crowning the elevation is the stucco-clad gable end, which contains a small pair of double hung one-over-one-light wood sash windows.

Interior

Impressive as the exterior of the Dahle house is, it is more than matched by the elaborate and intact interior. One passes through the main door into a small oak-paneled entrance vestibule that is floored in small square green tiles and then through a twenty-light, oak-framed inner door into the entrance hall.⁴ Placed on either side of the door are window seats that have radiators underneath them, hidden from view by wood paneling and metal grillwork. The floor of the entrance hall is varnished oak, as are all the floors in the main rooms of this story, and the walls of the hall are clad in tall, paneled, varnished quarter-sawn oak wainscot that extends upward to cover nearly three-quarters of the height of the room; the remaining quarter being plastered and papered. Varnished oak beams span the plaster ceiling, oak crown molding encircles it, and the principal staircase to the second story is placed across the rear (west) wall of the hall and features a tall closed balustrade having an oak handrail. To the right of the hall is the music room, which is reached through a pair of fifteen-light French style oak doors, while to the left is the main living room, which is reached through an identical pair of doors. A third door opening, placed at the extreme left (south) end of the hall's west wall contains a single fifteen-light door that opens into a short passageway that leads to the dining room at the back of the house and whose right side consists of a coat closet.

The living room spans the entire south end of the house and it is lit by windows on three sides, has a plastered oak-beamed ceiling, and plastered walls that are encircled by very tall, quarter-sawn oak baseboard trim and by a thin picture rail and wider crown molding.⁵ The focal point of the room is the fireplace, which is centered on the room's west end wall and which still retains its original varnished oak mantle and its green tile-clad surround and hearth. To the right of the fireplace on the north wall of the room is second pair of fifteen-light French style oak doors that lead into the dining room, the most elaborate room in the house. Like the entrance hall, this room also has oak-paneled wainscoting that extends about two-thirds of the way up the walls, which are otherwise coated in plaster. The dining room walls, however, terminate in an elaborately carved plaster crown molding that was painted or

⁴ This door and all the other multi-light first story doors have lights made out of beveled plate glass.

⁵ This room still retains its two original semi-indirect hanging ceiling light fixtures, which have superb frosted and etched Steuben glass bowls. A single example also hangs from the center of the ceiling in the dining room as well.

United States Department of the Interior
National Park Service

National Register of Historic Places
Continuation Sheet

Section 7 Page 6

Dahle, Henry L. and Sarah, House
Mount Horeb, Dane Co., WI

stained to closely resemble oak. Crowning the room is a shallowly vaulted plaster ceiling, which is elaborately laced with raised and carved plaster strapwork. The room's most impressive feature is a beautiful constructed built-in oak sideboard that occupies most of the room's east wall. This showpiece is flanked on either side by identical fifteen-light, oak-framed doors, the one on the left of which opens into a passageway that leads to the entrance hall, and the one on the left fronting a full-height china closet. The sideboard itself has four flat upper cabinets that have glass-fronted doors framed in art glass, while the quarter-sawn oak lower portion has a bow front whose drawers and cabinets are also bowed. A solid, quarter-sawn oak single panel door set in the north wall of the dining room leads into the kitchen, which still retains much of its original painted wood cabinetry, as does the adjoining pantry, which leads through another solid wood single panel door into the music room that occupies the northeast corner of the first story. This last room is less elaborate than the other principal rooms but it too has plaster walls and ceiling and the same tall quarter-sawn oak baseboards that are found in the other rooms.

The second story contains a large central hall that encircles the top of the main staircase, which opens into the center of the room and whose opening is encircled on three sides by a solid, plaster balustrade that is capped with oak hand rails. Four bedrooms and a marvelously intact and original tile bathroom are situated around the north, south, and west sides of this hall. The east side of the hall is deeper than the other three sides and forms a sitting area that looks out through three windows placed in the room's east wall onto Fourth Street. All of these rooms have plaster walls and ceilings and they, like the first story rooms, still retain an extremely high degree of integrity, and the whole ensemble is believed to be both one of the most elaborate and most intact examples of Claude & Starck's surviving residential designs.

8. Statement of Significance

Applicable National Register Criteria
(Mark "x" in one or more boxes for the criteria qualifying the property for the National Register listing.)

- A Property is associated with events that have made a significant contribution to the broad patterns of our history.
- B Property is associated with the lives of persons significant in our past.
- C Property embodies the distinctive characteristics of a type, period, or method of construction or represents the work of a master, or possesses high artistic values, or represents a significant and distinguishable entity whose components lack individual distinction.
- D Property has yielded, or is likely to yield, information important in prehistory or history.

Areas of Significance
(Enter categories from instructions)

Architecture

Period of Significance

1916

Significant Dates

1916

Criteria Considerations
(Mark "x" in all the boxes that apply.)

Property is:

- A owned by a religious institution or used for religious purposes.
- B removed from its original location.
- C a birthplace or grave.
- D a cemetery.
- E a reconstructed building, object, or structure.
- F a commemorative property.
- G less than 50 years of age or achieved significance within the past 50 years.

Significant Person
(Complete if Criterion B is marked)

N/A

Cultural Affiliation

N/A

Architect/Builder

Claude & Starck

Narrative Statement of Significance
(Explain the significance of the property on one or more continuation sheets.)

United States Department of the Interior
National Park Service

National Register of Historic Places
Continuation Sheet

Section 8 Page 1

Dahle, Henry L. and Sarah, House
Mount Horeb, Dane Co., WI

The Henry L. Dahle house is being nominated to the National Register of Historic Places (NRHP) for its local significance under National Register (NR) criterion C. More specifically, the Dahle house is being nominated because of its association with the area of Architecture, a theme identified in the State of Wisconsin's Cultural Resource Management Plan (CRMP). Research was undertaken to assess the NRHP potential of the Dahle house utilizing the Prairie School style subsection of the Architectural Styles study unit of the CRMP.⁶ The results of this research are detailed below and confirm that the Dahle house is locally significant under NR criterion C as a very fine and highly intact example of a single family residence designed in the Prairie School style. The significance is further enhanced by the house's elaborate interior and by its exceptionally intact and well maintained state of preservation.

The Henry L. and Sarah Dahle house was designed by the Madison, Wisconsin architectural firm of Claude & Starck, a firm which is especially noted for its important Prairie School designs, most of which are located in Wisconsin. Claude & Starck's client, Henry L. Dahle, was a member of one of Mt. Horeb's most important families. His father, Onon B. Dahle, a pioneer general store owner in nearby Perry Township, established the village of Daleyville. In 1895, the father moved to Mt. Horeb, where his two oldest sons, J. Theodore Dahle and Herman B. Dahle, the latter of whom was later a U.S. congressman from this district, had already started another general store in 1885. These two brothers also started the State Bank of Mt. Horeb with their father in 1891, and the third and youngest brother, Henry L. Dahle, later joined them in partnership. With the bank, the general store and their other ventures, the brothers soon became the principal merchants of Mt. Horeb and Henry L. Dahle had just begun the construction of his new Claude & Starck-designed home when he was stricken with appendicitis and died in 1916. His widow then completed the house and she and, later, her daughter, Alice, lived there until the house finally left the family in the mid-1990s.

History

Like so many other Wisconsin communities that were founded in the mid-nineteenth century, the history of the city of Mount Horeb owes its existence to proximity to early transportation routes and its prosperity to the coming of the railroad. The first land transportation route in this area was the Military Road, built between 1832 and 1837 to provide a land supply route that could serve U. S. Army forts located in Green Bay on Lake Michigan, Prairie du Chien on the Mississippi River, and Portage at the place of connection between the Fox and Wisconsin rivers. Because this was the closest thing to an actual statewide highway in Wisconsin in the 1830s, a number of communities developed along its route. This was especially true at places where the Military Road intersected with the routes

⁶ Wyatt, Barbara (Ed.) *Cultural Resource Management in Wisconsin*. Madison: State Historical Society of Wisconsin, 1986, Vol. 2, 2-21 (Architecture).

**United States Department of the Interior
National Park Service**

**National Register of Historic Places
Continuation Sheet**

Section 8 Page 2

Dahle, Henry L. and Sarah, House
Mount Horeb, Dane Co., WI

of later roads that were built by settlers who were moving into Wisconsin in ever increasing numbers. Mount Horeb, whose earliest beginnings were centered on just such an intersection, is one such community and was originally known as "the Corners" as a result.

It [the Military Road] was the main traveled route between Madison and Blue Mounds and on to Dodgeville until the coming of the railroad in 1881. Its route from Pheasant Branch on Lake Mendota was by way of Pine Bluff and followed the present Highways S and 78 leading south to the Corners. At a point near the southwest corner of the present cemetery, the four spikes of the Corners met. They were the Military Road North, the Military Road West, the Badger Mill Road to Verona [East], and the Mt. Vernon Road [South]. At the Corners the Old Military Road turned westward as it continued on its way to the Mounds [Blue Mounds].⁷

One of the earliest purchasers of land in the vicinity of the Corners was James Morrison, who patented a large tract of land that included much of the site of the present city of Mt. Horeb in 1849. Within a year part of this land was sold to Granville Neale and shortly thereafter to Ole Peterson. Other important early settlers were the Dryden brothers and Charles Carver, whose subsequent sales of land in the vicinity of the Corners intersection served to form the nucleus of the small hamlet that developed there.

The Corners evolved into Mt. Horeb in 1867, when the former post office of that name kept in what is today the nearby village of Blue Mounds was moved to the slightly larger community of the Corners, which became "Horeb's Corners," and later "Mount Horeb."⁸ In the years that followed, institutions and businesses of the kind typically associated with early community development were built in this location. By 1881, Mt. Horeb contained a school, two churches, at least two stores, a harness shop, blacksmith shop, wagon shop, and a hotel, along with a number of residences. In other words, Mt. Horeb was a typical crossroads community of that time, one that served the basic needs of the farmers in its immediate vicinity, and had it not been for the coming of the railroad it would probably have remained at this level of development.

Throughout the first 15 years of Mt. Horeb's existence, its nearest rail service was at Black Earth. The Chicago, Milwaukee, and St. Paul owned the line. All merchandise and supplies necessary for the businessman, carpenter, or farmer were picked up at Black Earth and it was

⁷ *Mount Horeb: Presettlement to 1986*. Mt. Horeb Area Historical Society, 1986, p. 3. Today, this is the intersection of STH 78 (north), STH 92 (south), and Main Street (old USH 18-151, east and west).

⁸ *Ibid.*, p. 4.

United States Department of the Interior
National Park Service

National Register of Historic Places
Continuation Sheet

Section 8 Page 3

Dahle, Henry L. and Sarah, House
Mount Horeb, Dane Co., WI

there that they disposed of their products. ... The one-way trip took two to three hours, depending on the weather, road condition, and the weight of the load to be hauled.⁹

The limited and quite isolated nature of Mt. Horeb's economic and social life underwent a radical change with the coming of the railroad in 1881.

The Chicago and Northwestern Railroad through Mt. Horeb was built in 1881. The station was placed one-half mile from the early settlement, bringing about a relocation of some of the homes and business places already established there. Merchants from other localities also elected to settle in the new location since transportation is an important factor in the business world.¹⁰

Among the merchants from other localities that moved to Mt. Horeb to take advantage of the new railroad connections, none had a larger impact on the future city than the three sons of Onon B. Dahle. O. B. Dahle (1823-1905) was born in Norway and after receiving his education, taught school there until emigrating to the United States in 1848. Upon arrival, Dahle went immediately to Wisconsin, where he struggled for two years to make a living. In 1850, Dahle and a cousin, Knute Dahle, left for the California goldfields, where they eventually "struck it rich" in a modest way. With their earnings intact, the two men returned to Wisconsin in 1853, whereupon O. B. Dahle opened a general store (non-extant) in the Town of Perry.¹¹ The following year, Dahle married Betsy Nelson of Racine and a year later saw the birth of their first child, Herman Bjorn Dahle (1855-1920). By 1863, when his daughter Marie Dahle (Peterson) (1863-?) was born, Dahle's business success had been largely responsible for the development of a crossroads community of his own at that location, which was named Daleyville in his honor. A year later, Dahle's second son, J. Theodore Dahle (1864-1908), was born and the family moved into a handsome new stone Italianate style house that is still extant in Daleyville. The following year, Dahle's third son, Henry L. Dahle (1865-1916), was born, and he, like his brothers and sister, would be educated first in the local schools and subsequently, at the University of Wisconsin.

⁹ *Mount Horeb: Presettlement to 1986*. Mt. Horeb Area Historical Society, 1986, p. 4. The village of Black Earth is located approximately 12 miles to the north of Mt. Horeb.

¹⁰ *Ibid*, p. 14. The earlier settlement soon acquired the nickname "Old Town" and the one that developed around the railroad station, "New Town." Both have now been absorbed into the larger city that has developed around them since then.

¹¹ Keyes, Elisha W. (ed.) *History of Dane County: Biographical and Genealogical*. Madison; Western Historical Association, 1906, pp. 215-217.

**United States Department of the Interior
National Park Service**

**National Register of Historic Places
Continuation Sheet**

Section 8 Page 4

Dahle, Henry L. and Sarah, House
Mount Horeb, Dane Co., WI

In 1877, after attending the University, Herman B. Dahle married Anne Kittleson of Perry. The new couple then moved to the nearby community of Mt. Vernon, located seven miles south of Mt. Horeb, where Dahle opened a general store of his own with help from his father. Like his father, Herman Dahle seems to have been able to turn all his ventures into successes and in 1887, after ten successful years in Mt. Vernon, he sold his store and with his family moved to Mt. Horeb, where Dahle had earlier established an ice house (non-extant) that provided cold storage for the butter and eggs distributing business that he had developed as an adjunct to his general store. In Mt. Horeb, Dahle built a new general store (extant) that was subsequently enlarged in 1904 and which was Mt. Horeb's principal retail store until it ceased operations in 1929.¹² In addition, Dahle, his father, and another man incorporated the State Bank of Mt. Horeb in 1891. In the same year Dahle also brought his brother, Theodore into the business, who was subsequently followed by the third brother, Henry, who married Sarah Bergh in 1896.

In 1897, Onon B. Dahle retired and moved from Daleyville to Mt. Horeb, where the impressive new brick-clad Queen Anne style house that he had built still stands.¹³ A year later, his son Herman ran successfully for the office of U.S. Congressman from this district, an office he would fill until 1902. During his period in Washington D.C., Herman Dahle's business affairs were looked after by his brothers and by his oldest son, Otto. B. Dahle.¹⁴ Onon B. Dahle died in 1905 and his son, Theodore Dahle, died in 1908, after which Henry assumed an increasingly large share of the responsibility for the various family enterprises. By 1914, Henry Dahle had retired from active participation in these businesses and he was about to embark on the construction of a new home to house his wife and daughter, Alice. These events were all faithfully chronicled in the local newspapers.

H. L. Dahle has sold his spacious residence on Main Street to C. M. Grinstead, and will give possession on March 1. Mr. Dahle says his only reason for selling his elegant property was that it was out of proportion to the size of his family. We are not prone to believe that H. L. and his family will leave Mt. Horeb but feel as we hope they will remain steadfast citizens of Mt. Horeb.¹⁵

¹² *Mount Horeb: Presettlement to 1986*. Mt. Horeb Area Historical Society, 1986, pp. 22-23 (illustrated).

¹³ *Ibid*, p. 51 (illustrated).

¹⁴ Dahle, Thomas Locke. "A History and Genealogy of the Dahle-Kirtleson and Locke-Ness Families." Typescript M.S. in the collection of the Wisconsin Historical Society. 1984.

¹⁵ *Mt. Horeb Times*: October 16, 1914, p. 1.

**United States Department of the Interior
National Park Service**

**National Register of Historic Places
Continuation Sheet**

Section 8 Page 5

Dahle, Henry L. and Sarah, House
Mount Horeb, Dane Co., WI

By March of the following year Dahle had rented a new place in Mt. Horeb, the G. E. Mickelson house, and was ready to embark on the construction of his new house.¹⁶ The site of his future house is located in one of Mt. Horeb's finest historic neighborhoods, a neighborhood that grew up around the Lutheran Academy grounds on Academy Street. This substantial brick Queen Anne style building (non-extant) had been built in 1893 on land donated by Herman Dahle, and in 1903, after the Academy closed, it was turned into Mt. Horeb's high school. By mid-1916, and with his house under construction, Henry Dahle also accepted a nomination from the county Republican Party to run for the Wisconsin State Senate. Sadly, before either of these events could come to pass, Henry Dahle was stricken with appendicitis and died in Madison hospital on July 15, 1916, at the age of 50.¹⁷

The funeral was held on Monday afternoon and was the largest ever witnessed in this part of the county, brief services were held at the house and where the relatives took the last parting look.¹⁸

It was therefore left to Henry Dahle's widow to finish the house that he never saw completed, which occurred later in the same year.

Mrs. Sarah Dahle and daughter Miss Alice are now domiciled in their elegant new house on 4th street which has been under construction for some time and is a model residence in architecture and completeness planned and partly built before the death of Mr. Dahle. We trust the ladies will enjoy this beautiful home and its comforts as certainly was the intention of the designer.¹⁹

Sarah Dahle never remarried and she lived in her house until her death in 1939. Her daughter Alice and her family lived in the house until it was finally sold out of the family in the mid-1990s. The Dahle house was subsequently bought by Dr. Ralph & Lillian McGrew in 1999 and they have taken great pains to restore the house to its original state, being greatly aided by the unaltered condition that was a legacy of eighty years of continuous Dahle family occupancy.

¹⁶ *Mt. Horeb Times*. January 22, 1915, p. 5.

¹⁷ *Madison Democrat*. July 15, 1916.

¹⁸ *Mt. Horeb Times*. July 21, 1916, p. 8.

¹⁹ *Ibid*, October 20, 1916, p. 1.

United States Department of the Interior
National Park Service

National Register of Historic Places
Continuation Sheet

Section 8 Page 6

Dahle, Henry L. and Sarah, House
Mount Horeb, Dane Co., WI

Architecture

The Henry L. Dahle house is believed to be eligible for listing in the NRHP because it is one of the finest extant examples of the important group of Prairie School style residences designed by the Madison, Wisconsin firm of Claude & Starck in the first two decades of the twentieth century and it is also the finest Prairie School style building in the city of Mt. Horeb. This significance is considerably enhanced by the high degree of integrity that is still present in the fabric of the Dahle house today.

As the Prairie School style subsection of the CRMP notes: "Horizontality was the essence of Prairie School design, emphasized by a low, long hipped or gable roof, windows banded in horizontal ribbons, and the use of an emphatic belt course or shelf roof between stories."²⁰ All of these elements are to be found in the design of the Dahle house, whose exterior also makes use of wood, brick and stucco, which the CRMP further notes were the materials generally used for Prairie School buildings.

Claude and Starck was Madison's most prolific architectural firm in the first two decades of the twentieth century. The principals of the firm, which was in existence from 1895 - 1929, were Louis W. Claude (1868-1951), who was its principal designer, and Edward F. Starck (1868-1947), who was the managing partner. The two men were both Wisconsin natives who formed a partnership in 1895, three years after Claude had returned from Chicago and a position in the offices of Louis Sullivan, where he developed a life-long relationship with Frank Lloyd Wright. Their new firm lasted until 1929, during which time it produced many of Madison and Wisconsin's most outstanding buildings, ranging from schools to residences, retail buildings and factories. Their most important work, though, was done in the Prairie School style, the most notable examples being a series of outstanding small libraries that they designed for communities in Wisconsin, Illinois, Michigan, Minnesota, and as far away as Washington state. It is with this work that they are now most closely associated and best known. Claude & Starck completed three known projects in Mt. Horeb. Their house for Henry L. Dahle, designed in 1915, and built in 1916, was the first.²¹ The second was the now non-extant State Bank of Mt. Horeb (105 S. First St.),²² and the third was the much larger Prairie School style-influenced Mt. Horeb Public School building, designed in 1917 and completed in 1919, which is located on Academy

²⁰ Wyatt, Barbara (Ed.). *Cultural Resource Management in Wisconsin*. Historic Preservation Division, State Historical Society of Wisconsin, Madison, Wisconsin, 1986. Vol. 2, 2-21 (Architecture).

²¹ Orr, Gordon D. Jr. "Louis W. Claude: Madison Architect of the Prairie School." *The Prairie School Review*, Vol. XIV, pp. 11 & 26.

²² *Mt. Horeb Times*. June 22, 1917, p. 8. See also: *Mount Horeb: Presettlement to 1986*. Mt. Horeb Area Historical Society, 1986, p. 25.

United States Department of the Interior
National Park Service

National Register of Historic Places
Continuation Sheet

Section 8 Page 7

Dahle, Henry L. and Sarah, House
Mount Horeb, Dane Co., WI

Street a block away from the Dahle House.²³ Both the Dahle House and the School are still largely intact today and they are excellent examples of Claude & Starck's mature Prairie School style work.

In his excellent *Prairie School Review* article on the firm, Gordon D. Orr, Jr. placed the Dahle house within a context that includes Claude & Starck's later Prairie School designs, designs that he considered to be particular to this firm.

Departing from the Wrightian form and developing a style more their own are a series of impressive residences with a distinctive Prairie School form: the William Collins House at 704 Gorham Street (1911), the H. L. Dahle House at 312 Fourth Street in Mt. Horeb (1915), ... the Emil Hokanson House at 1047 Sherman Ave. (1916), ... the William Beecroft House at 514 N. Carroll St. (1910), the William Knight House at 2124 Tenth Street in Monroe (c1917), and the Ben Roderick House, 607 W. Second Ave., Brodhead (c1917). These residences have horizontal expressions of deeply raked brick joints, broad gable roofs overhanging the walls to create strong shadow lines, a building mass composed of simple geometric forms, rows of windows tied together to emphasize a horizontal feeling, and materials generally earthy in their tones. The Collins, Knight, Roderick, Dahle and Hokanson Houses possess ornamental brackets and balustrades that express a debt to the arts and crafts movement; nevertheless these details are synthesized into a coherent composition. Pilasters on the end walls, some with stone or concrete caps, might be more readily identified with classical entablatures, and are far from the classical in the building statements of the Hokanson, Dean and Beecroft Houses. Instead, they are used to provide solid terminations at the wall corners. Leaded glass is to be found in many of these designs in door sidelights and windows.

During the period from 1896 through 1917 the residential work of the firm of Claude and Starck shows a growth from a large, heavy composition similar to some of George Maher's work, and another form evolving out of the Tudor style, perhaps also influenced by Maher. Only a few designs can be considered to be directly influenced by Wright, while a significantly larger number from the later years of their residential work are more nearly their own version of the Prairie School.²⁴

The Dahle house also possesses features that are closely associated with other examples of Claude and Starck's later residential designs such as very wide overhanging eaves that have stucco-covered soffits ornamented with narrow wood strips that run the length of the eaves. This decorative motif occurs on

²³ Orr, Gordon D. Jr. Op. Cit., p. 31.

²⁴ Ibid, pp. 12-13.

United States Department of the Interior
National Park Service

National Register of Historic Places
Continuation Sheet

Section 8 Page 8

Dahle, Henry L. and Sarah, House
Mount Horeb, Dane Co., WI

several of the later houses of the firm and it serves to both emphasize the horizontal aspects of the overall design and also to outline and emphasize the roof.

The Henry L. Dahle house is not only an important example of Claude and Starck's later Prairie School work but it also contains one of the firm's most elaborate and consistently executed interiors as well. The Dahle house is thus believed to be locally significant under National Register Criterion C in the area of Architecture as an excellent, highly intact example of the later Prairie School style residential designs produced by the firm of Claude & Starck, designs which are an important part of Wisconsin's architectural heritage. The Dahle House possesses many of the typical features associated with Prairie School style houses of its time such as a pronounced horizontal emphasis, grouped and banded windows, and siding materials such as brick and stucco, materials that are typical of the style. The house also features certain design elements such as very wide overhanging eaves having soffits decorated with wood trim, that are especially associated with the work of the firm. In addition, the building's elegant, largely original interior adds considerably to the overall significance of the house.

Dahle, Henry L. and Sarah, House
Name of Property

Dane
County and State

Wisconsin

9. Major Bibliographic References

(Cite the books, articles, and other sources used in preparing this form on one or more continuation sheets.)

Previous Documentation on File (National Park Service):

- preliminary determination of individual listing (36 CFR 67) has been requested
- previously listed in the National Register
- previously determined eligible by the National Register
- designated a National Historic landmark
- recorded by Historic American Buildings Survey #
- recorded by Historic American Engineering Record #

Primary location of additional data:

- State Historic Preservation Office
- Other State Agency
- Federal Agency
- Local government
- University
- Other

Name of repository:

10. Geographical Data

Acres of Property Less than one acre

UTM References (Place additional UTM references on a continuation sheet.)

1 16 277060 4764720
Zone Easting Northing

3 _____
Zone Easting Northing

2 _____
Zone Easting Northing

4 _____
Zone Easting Northing

See Continuation Sheet

Verbal Boundary Description (Describe the boundaries of the property on a continuation sheet)

Boundary Justification (Explain why the boundaries were selected on a continuation sheet)

11. Form Prepared By

name/title Timothy F. Heggland
organization
street & number 6391 Hillsandwood Rd.
city or town Mazomanie

state WI

date December 31, 2002
telephone (608)-795-2650
zip code 53560

United States Department of the Interior
National Park Service

National Register of Historic Places
Continuation Sheet

Section 9 Page 1

Dahle, Henry L. and Sarah, House
Dane County, WI

Major Bibliographical References

Dahle, Thomas Locke. "A History and Genealogy of the Dahle-Kirtleson and Locke-Ness Families." Typescript M.S. in the collection of the Wisconsin Historical Society. 1984.

Keyes, Elisha W. (ed.) *History of Dane County: Biographical and Genealogical*. Madison: Western Historical Association, 1906.

Madison Democrat, July 15, 1916 (obituary of Henry L. Dahle).

Mount Horeb: Presettlement to 1986. Mt. Horeb Area Historical Society, 1986.

Mt. Horeb Times. See individual citations in the footnotes.

Orr, Gordon D. Jr. "Louis W. Claude: Madison Architect of the Prairie School." *The Prairie School Review*, Vol. XIV.

Wyatt, Barbara (Ed.). *Cultural Resource Management in Wisconsin*. Historic Preservation Division, State Historical Society of Wisconsin, Madison, Wisconsin, 1986. Vol. 2 (Architecture).

**United States Department of the Interior
National Park Service**

**National Register of Historic Places
Continuation Sheet**

Section 10 Page 1

Dahle, Henry L. and Sarah, House
Mount Horeb, Dane County, WI

Boundary Description

Lingard's Addition to Mount Horeb. Block 7: E 135' Lot 9, E 135' Lot 10, and E 135' Lot 11.

Boundary Justification

The boundaries enclose all the land historically associated with the Henry L. Dahle House

Dahle, Henry L. and Sarah, House
Name of Property

Dane
County and State

Wisconsin

Additional Documentation

Submit the following items with the completed form:

Continuation Sheets

Maps A USGS map (7.5 or 15 minute series) indicating the property's location.
A sketch map for historic districts and properties having large acreage or numerous resources.

Photographs Representative black and white photographs of the property.

Additional Items (Check with the SHPO or FPO for any additional items)

Property Owner

Complete this item at the request of SHPO or FPO.)

name/title	Ralph & Lillian McGrew	date	December 2002
organization		telephone	608/437-3990
street & number	312 South Fourth Street	zip code	53572
city or town	Mt. Horeb	state	WI

Paperwork Reduction Act Statement: This information is being collected for applications to the National Register of Historic Places to nominate properties for listing or determine eligibility for listing, to list properties, and to amend existing listings. Response to this request is required to obtain a benefit in accordance with the National Historic Preservation Act, as amended (16 U.S.C. 470 et seq.).

Estimated Burden Statement: Public reporting burden for this form is estimated to average 18.1 hours per response including time for reviewing instructions, gathering and maintaining data, and completing and reviewing the form. Direct comments regarding this burden estimate or any aspect of this form to the Chief, Administrative Services Division, National Park Service, P.O. Box 37127, Washington, DC 20013-7127; and the Office of Management and Budget, Paperwork Reductions Projects, (1024-0018), Washington, DC 20503.

United States Department of the Interior
National Park Service

National Register of Historic Places
Continuation Sheet

Dahle, Henry L. and Sarah, House
Mount Horeb, Dane County, WI

Section photos Page 1

Items a-d are the same for photos 1 - 10.

Photo 1

- a) Henry L. Dahle House
- b) Mt. Horeb, Dane County, WI
- c) Timothy F. Hegglund, April 16, 2002
- d) Wisconsin Historical Society
- e) General View looking W
- f) Photo 1 of 10

Photo 9

- e) Dining Room, View facing N
- f) Photo 9 of 10

Photo 10

- e) Dining Room Sideboard, View facing NE
- f) Photo 10 of 10

Photo 2

- e) View looking NW
- f) Photo 2 of 10

Photo 3

- e) Rear Elevation. View looking NE
- f) Photo 3 of 10

Photo 4

- e) View looking SW
- f) Photo 4 of 10

Photo 5

- e) Mine Entrance, View looking W
- f) Photo 5 of 10

Photo 6

- e) Entrance Hall, View looking S
- f) Photo 6 of 10

Photo 7

- e) Entrance Hall, Stairs, View looking SW
- f) Photo 7 of 10

Photo 8

- e) Living Room, View looking W
- f) Photo 8 of 10

HENRY L. AND SARAH DAHLE HOUSE MT. HOREB, DANE CO., WISCONSIN

no scale

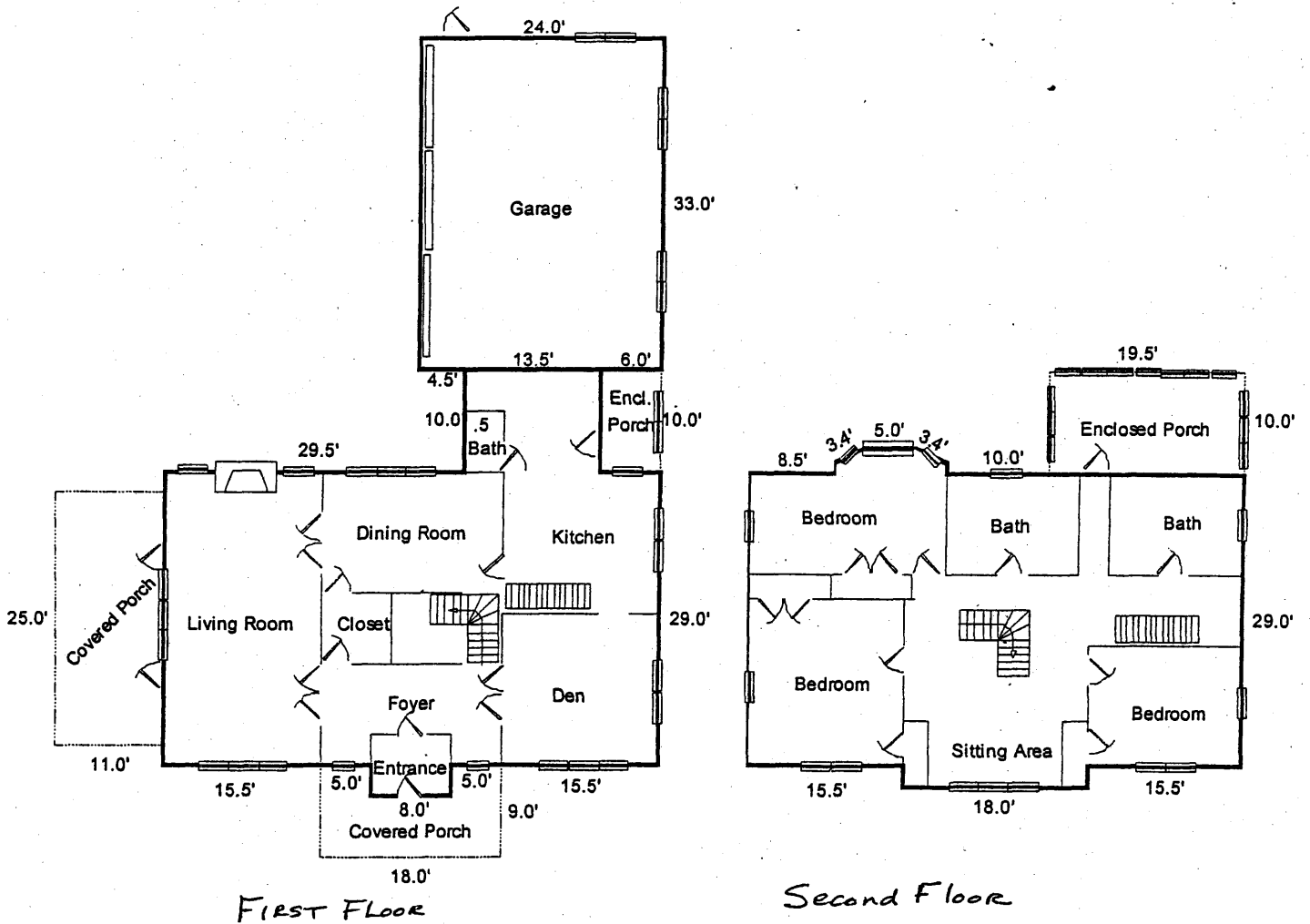
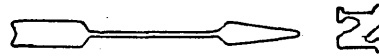

Sketch by Apex IV Windows™

AREA CALCULATIONS SUMMARY			
Code	Description	Size	Totals
GLA1	First Floor	1580.58	1580.58
GLA2	Second Floor	1480.00	1480.00
P/P	Covered Porch	275.00	
	Covered Porch	138.00	
	Enclosed Porch	60.00	
	Enclosed Porch	195.00	668.00
GAR	Garage	792.00	792.00
Total Livable (rounded)			3061

LIVING AREA BREAKDOWN		
	Breakdown	Subtotals
First Floor		
	3.0 x 8.0	24.00
	10.0 x 13.5	135.00
	29.0 x 49.0	1421.58
Second Floor		
	2.0 x 18.0	36.00
	1.0 x 11.0	11.00
	1.5 x 5.0	7.50
	0.5 x 3.0 x 1.5	2.25
	0.5 x 3.0 x 1.5	2.25
	29.0 x 49.0	1421.00
9 Areas Total (rounded)		3061



1914
JAMES H. HARRIS
1914-1915
1915-1916
1916-1917
1917-1918
1918-1919
1919-1920
1920-1921
1921-1922
1922-1923
1923-1924
1924-1925
1925-1926
1926-1927
1927-1928
1928-1929
1929-1930
1930-1931
1931-1932
1932-1933
1933-1934
1934-1935
1935-1936
1936-1937
1937-1938
1938-1939
1939-1940
1940-1941
1941-1942
1942-1943
1943-1944
1944-1945
1945-1946
1946-1947
1947-1948
1948-1949
1949-1950
1950-1951
1951-1952
1952-1953
1953-1954
1954-1955
1955-1956
1956-1957
1957-1958
1958-1959
1959-1960
1960-1961
1961-1962
1962-1963
1963-1964
1964-1965
1965-1966
1966-1967
1967-1968
1968-1969
1969-1970
1970-1971
1971-1972
1972-1973
1973-1974
1974-1975
1975-1976
1976-1977
1977-1978
1978-1979
1979-1980
1980-1981
1981-1982
1982-1983
1983-1984
1984-1985
1985-1986
1986-1987
1987-1988
1988-1989
1989-1990
1990-1991
1991-1992
1992-1993
1993-1994
1994-1995
1995-1996
1996-1997
1997-1998
1998-1999
1999-2000
2000-2001
2001-2002
2002-2003
2003-2004
2004-2005
2005-2006
2006-2007
2007-2008
2008-2009
2009-2010
2010-2011
2011-2012
2012-2013
2013-2014
2014-2015
2015-2016
2016-2017
2017-2018
2018-2019
2019-2020
2020-2021
2021-2022
2022-2023
2023-2024
2024-2025

312

















312



312









